

PARKING BRAKE DRUM

COMPONENT LOCATOR

EN01E09ZZZ180402014001

PARKING DRUM INNER DIAMETER: 177.8 mm (7.000 in.)

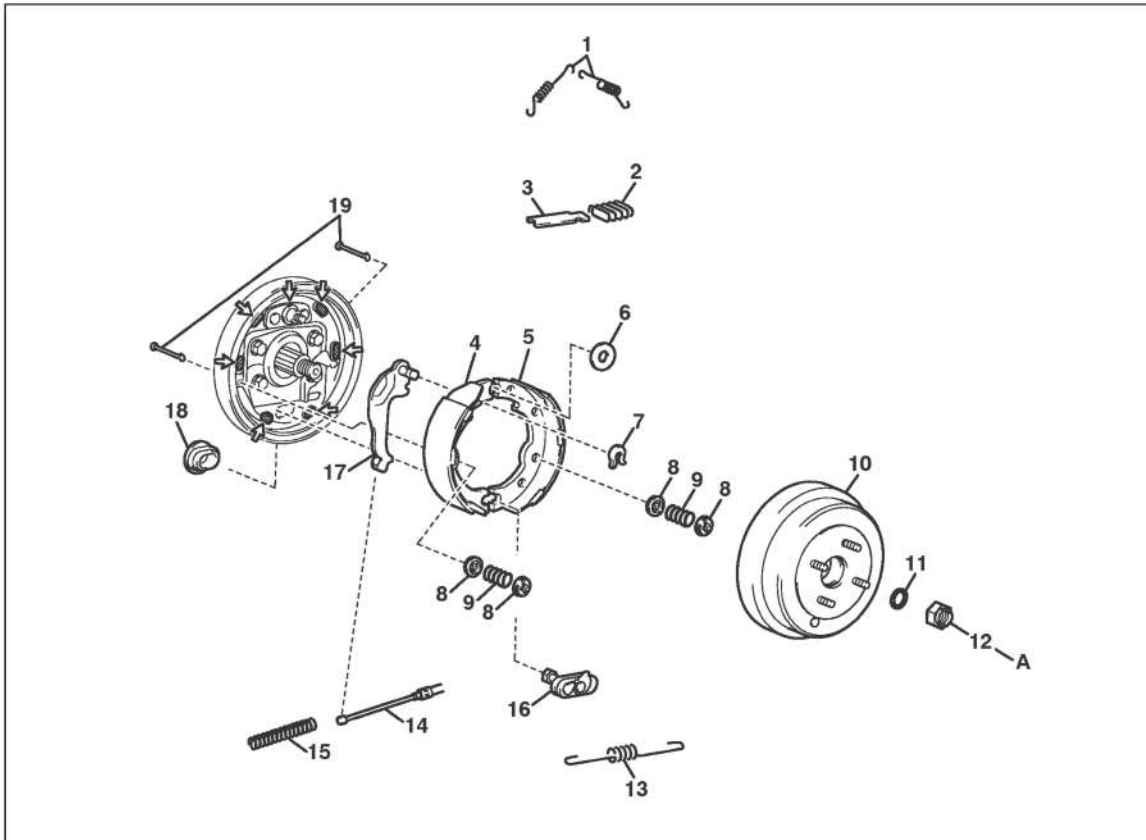

SHTS09ZZZ1800164

1	Parking brake shoe return tension spring No.1	11	O-ring *
2	Parking brake shoe strut compression spring	12	Output shaft set nut
3	Parking brake shoe lever strut	13	Parking brake shoe return tension spring No.2
4	Parking brake shoe No.1	14	Parking brake cable No.3
5	Parking brake shoe No.2	15	Parking cable inner wire spring
6	Plate washer	16	Parking brake shoe adjuster
7	C-washer *	17	Parking brake shoe lever
8	Parking brake shoe hold-down spring cup	18	Parking brake adjusting cam hole cover
9	Parking brake shoe hold-down spring	19	Parking brake shoe hold-down spring
10	Parking brake drum		

*: Nonreusable part

Tightening torque

Unit: N·m {kgf·cm, lbf·ft}

A	127 {1,295, 95} (Transmission M/T) 190 {1,937, 140} (Transmission A/T)	
---	---	--

Update Date : 2019-09-12 Print Date : 2020-02-27

9-322

BRAKE/PARKING BRAKE

PARKING DRUM INNER DIAMETER: 190 mm (7.480 in.)

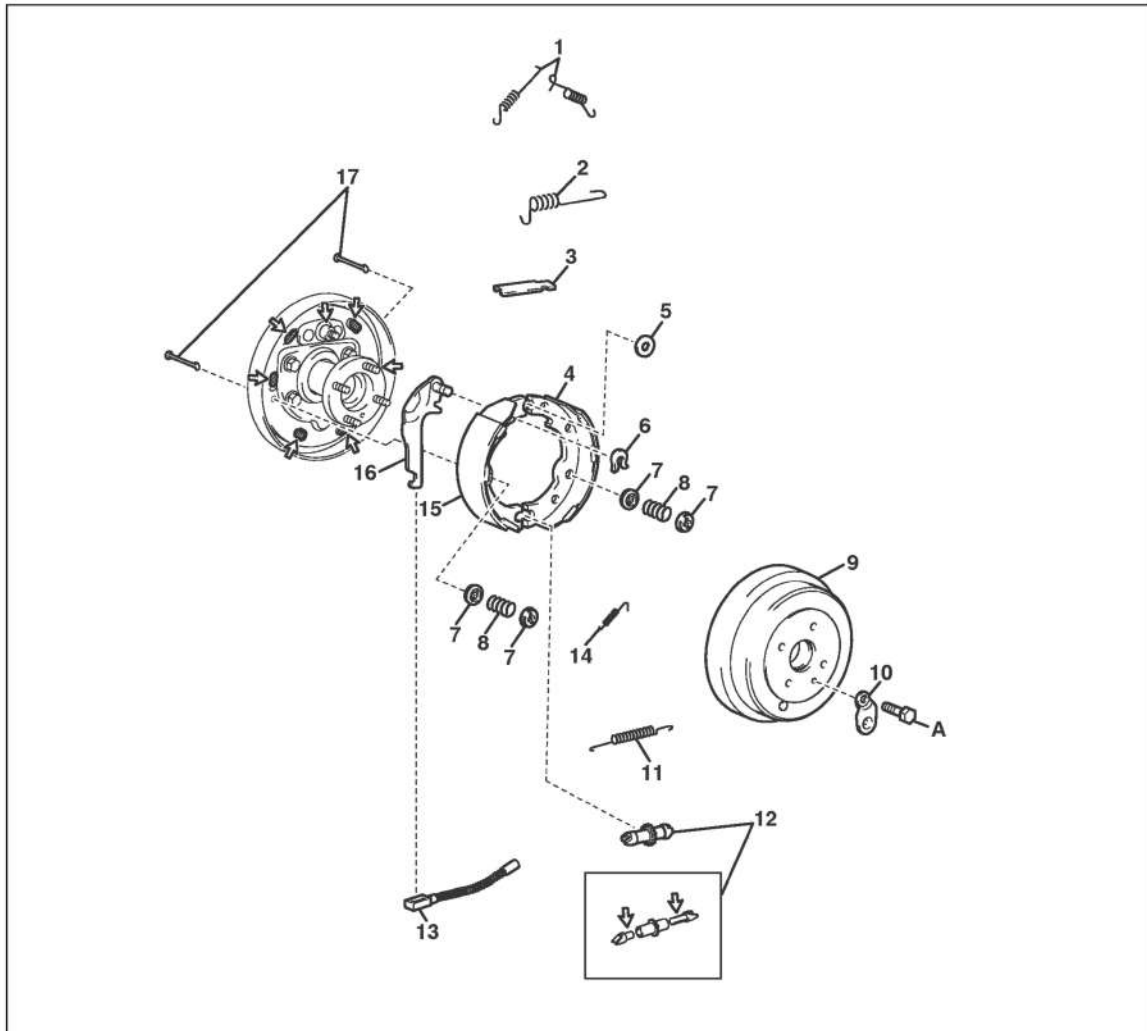

SHTS09ZZZ1800165

1	Parking brake shoe return tension spring No.1	10	Parking brake dust cover
2	Parking brake shoe strut compression spring	11	Parking brake shoe return tension spring No.2
3	Parking brake shoe lever strut	12	Parking brake shoe adjusting screw set
4	Parking brake shoe No.2	13	Parking brake cable No.3
5	Washer *	14	Parking brake shoe return tension spring No.3
6	C-washer *	15	Parking brake shoe No.1
7	Parking brake shoe hold-down spring cup	16	Parking brake shoe lever
8	Parking brake shoe hold-down spring	17	Parking brake shoe hold-down spring pin
9	Parking brake drum		

*: Nonreusable part

Tightening torque

Unit: N·m {kgf·cm, lbf·ft}

A	8.2 {84, 6.0}	
---	---------------	--

Update Date : 2019-09-12 Print Date : 2020-02-27

9-324

BRAKE/PARKING BRAKE

PARKING DRUM INNER DIAMETER: 203.2 mm (8.000 in.)

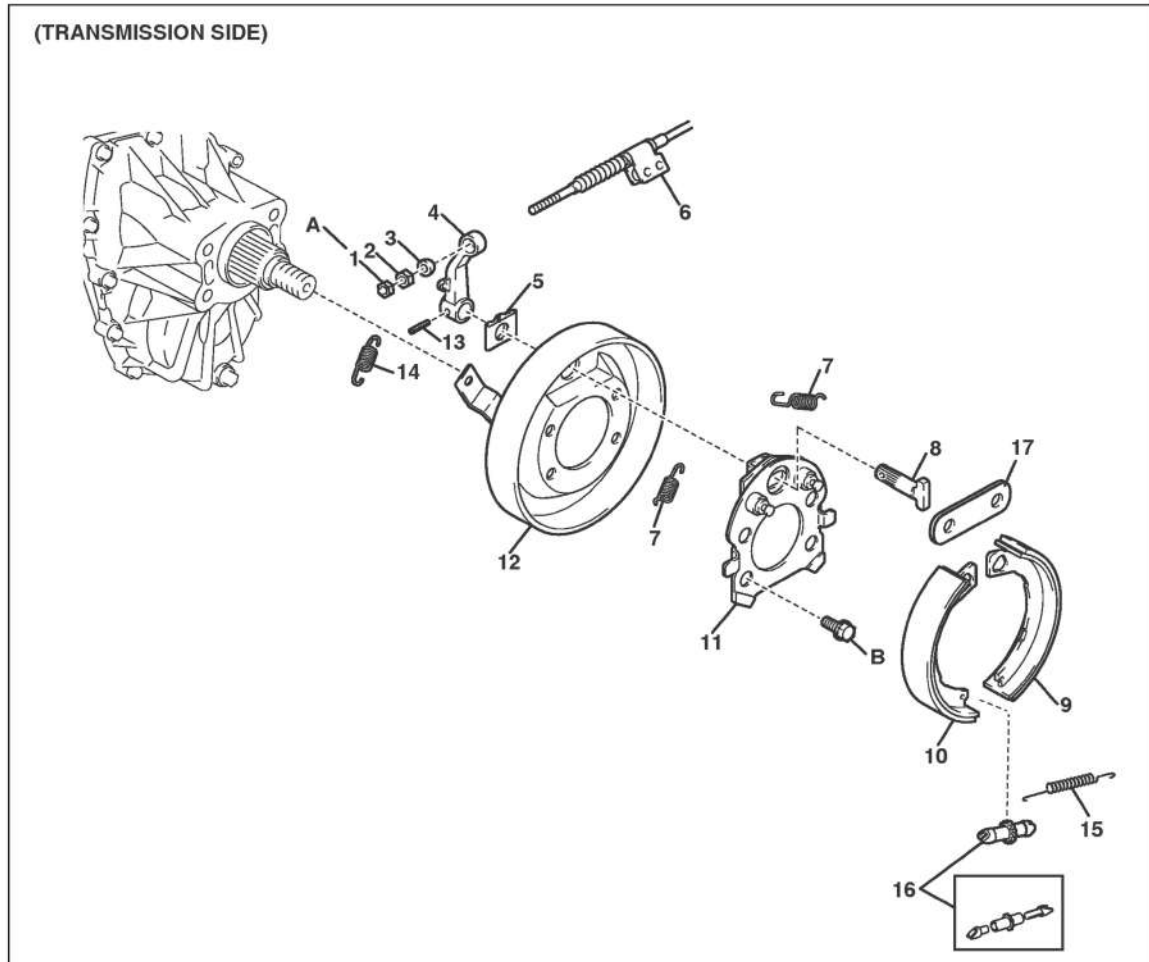

SHTS09ZZZ1800167

1	Adjusting nut	10	Parking brake shoe No.1
2	Adjusting nut	11	Support plate
3	Adjusting spacer	12	Parking brake support plate
4	Parking brake cam lever	13	Parking brake cam lever dowel pin
5	Parking brake cam lever spring	14	Parking brake lever spring
6	Parking brake cable No.3	15	Parking brake shoe return tension spring
7	Parking brake shoe return tension spring No.1	16	Parking brake shoe adjusting screw set
8	Parking brake cam No.1	17	Parking brake brace
9	Parking brake shoe No.2		

*: Nonreusable part

Tightening torque

Unit: N·m {kgf·cm, lbf·ft}

A	19.5 {199, 14}	B	155 {1,581, 114}
---	----------------	---	------------------

Update Date : 2019-09-12 Print Date : 2020-02-27

BRAKE/PARKING BRAKE

9-325

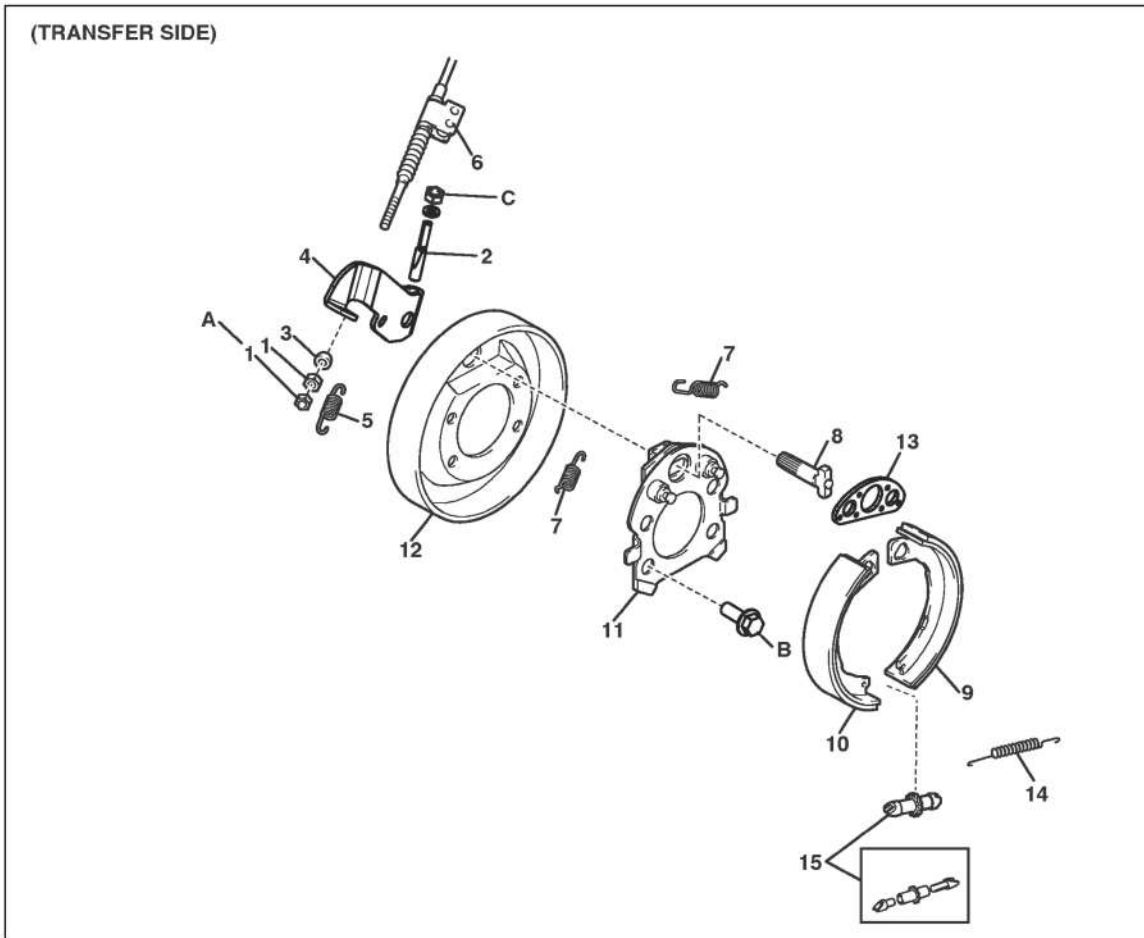

SHTS09ZZZ1800168

1	Adjusting nut	9	Parking brake shoe No.2
2	Lock pin	10	Parking brake shoe No.1
3	Adjusting spacer	11	Support plate
4	Parking brake cam lever	12	Parking brake support plate
5	Parking brake lever spring	13	Parking brake brace
6	Parking brake cable No.3	14	Parking brake shoe return tension spring
7	Parking brake shoe return tension spring No.1	15	Parking brake shoe adjusting screw set
8	Parking brake cam No.1		

*: Nonreusable part

Tightening torque

Unit: N·m {kgf·cm, lbf·ft}

A	19.5 {199, 14}	C	12.7-21.6 {130-220, 10-15}
B	37-49 {378-499, 28-36}		

OVERHAUL

EN01E09ZZZ180402014002

DISASSEMBLING THE PARKING BRAKE DRUM (PARKING DRUM INNER DIAMETER: 177.8 mm (7.000 in.))

1. REMOVE THE PROPELLER SHAFT.

Reference: PROPELLER SHAFT (LE), PROPELLER SHAFT MECHANICAL, PROPELLER SHAFT ASSEMBLY, OVERHAUL, REMOVING THE PROPELLER SHAFT ASSEMBLY (Page 6-7)

2. REMOVE THE PARKING BRAKE DRUM.

- (1) Pull the parking brake lever.
- (2) Using SST and a hammer, remove the staked portion of the output shaft set nut.

SST: 09930-00010

Drive shaft nut chisel

⚠ CAUTION

- Use SST with its tapered side facing toward the shaft.
- Do not grind the tip of SST with a grinder.

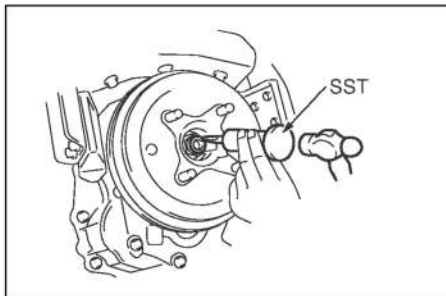

SHTS09ZZZ1800169

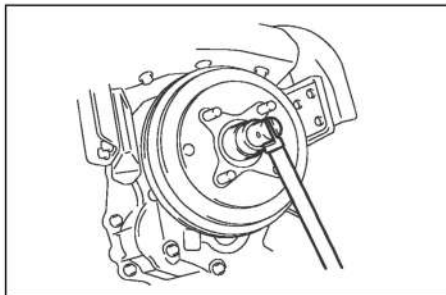

SHTS09ZZZ1800170

- (3) Using a socket wrench (32 mm (1.260 in.)), remove the output shaft set nut.

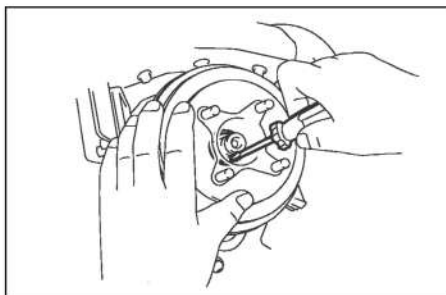

SHTS09ZZZ1800171

- (4) Using the flathead driver, remove the O-ring.

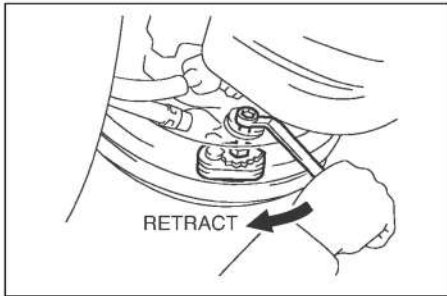

SHTS09ZZ1800172

- (5) Lower the parking brake lever and remove the parking brake drum.

NOTICE

If the brake drum cannot be removed easily, turn the shoe adjuster behind the backing plate clockwise to reduce the brake shoe expansion.

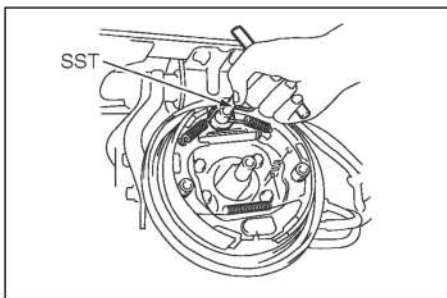

SHTS09ZZ1800173

3. REMOVE PARKING BRAKE SHOE RETURN TENSION SPRINGS NO.1.

- (1) Using SST, remove parking brake shoe return tension springs No.1 (2 pcs.).

SST: 09717-20010

Brake shoe return spring remover

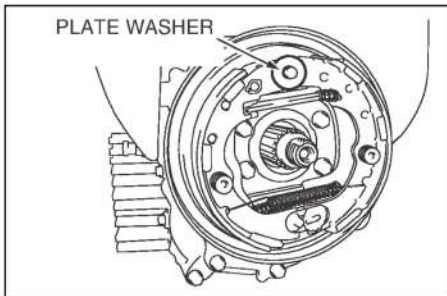

SHTS09ZZ1800174

- (2) Remove the plate washer.

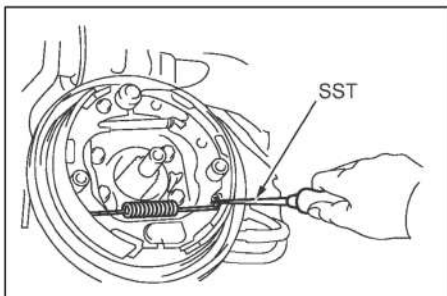

SHTS09ZZ1800175

4. REMOVE PARKING BRAKE SHOE RETURN TENSION SPRING NO.2.

- (1) Using SST, remove parking brake shoe return tension spring No.2.

SST: 09921-00011

Spring tension tool

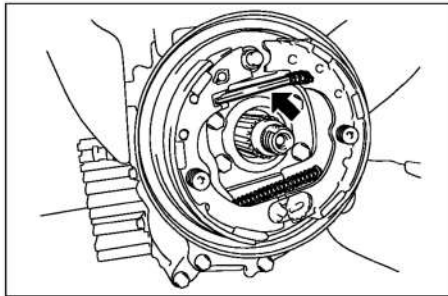

SHTS09ZZZ1800176

5. REMOVE PARKING BRAKE SHOE NO.2.

- (1) Remove the parking brake shoe lever strut and parking brake shoe strut compression spring.

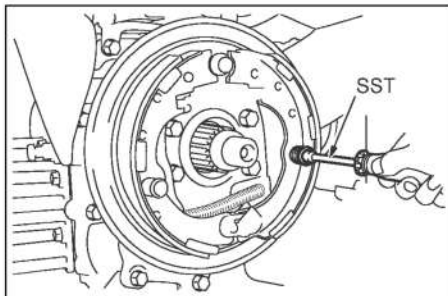

SHTS09ZZZ1800177

- (2) Using SST, remove the parking brake shoe hold-down spring, parking brake shoe hold-down spring cup, and parking brake shoe hold-down spring pin.

SST: 09718-00011

Shoe hold-down spring driver

- (3) Remove parking brake shoe No.2.

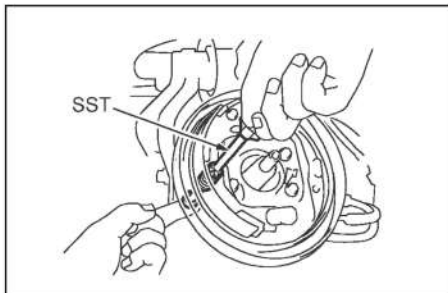

SHTS09ZZZ1800178

6. REMOVE PARKING BRAKE SHOE NO.1.

- (1) Using SST, remove the parking brake shoe hold-down spring cups (2 pcs.), parking brake shoe hold-down spring, and parking brake shoe hold-down spring pin from parking brake shoe No.1.

SST: 09718-00011

Shoe hold-down spring driver

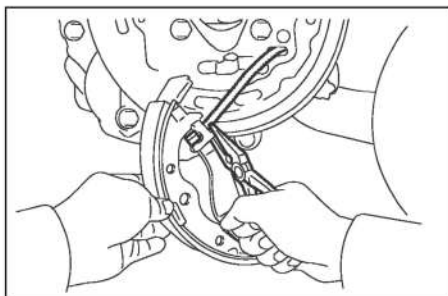

SHTS09ZZZ1800179

- (2) Using needle-nose pliers, disconnect parking brake cable No.3 from the parking brake shoe lever.

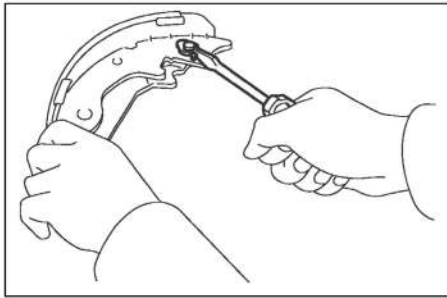

SHTS09ZZ1800180

7. REMOVE THE PARKING BRAKE SHOE LEVER ASSEMBLY.

- (1) Using the flathead driver, remove the C-washer, then remove the parking brake shoe lever from parking brake shoe No.1.

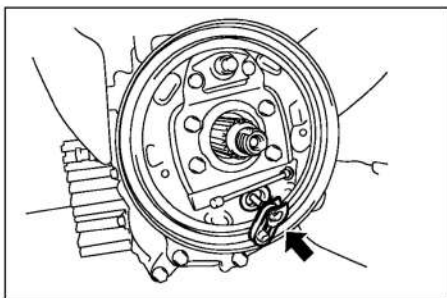

SHTS09ZZ1800181

8. REMOVE THE PARKING BRAKE SHOE ADJUSTER ASSEMBLY.

- (1) Remove the parking brake shoe adjuster.

INSPECTING THE PARKING BRAKE DRUM (PARKING DRUM INNER DIAMETER: 177.8 mm (7.000 in.))

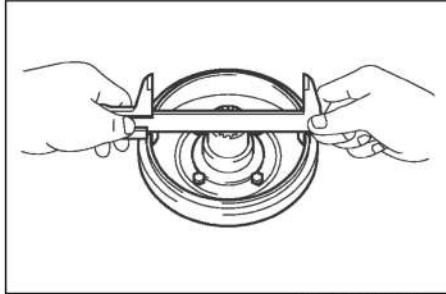

SHTS09ZZZ1800182

1. INSPECT THE BRAKE DRUM FOR WEAR AND DAMAGE.

- (1) Using vernier calipers, measure the inner diameter of the brake drum.

Permissible limit (mm {in.})	178.8 {7.039}
In the case of a new product (mm {in.})	177.8 {7.000}

- (2) If the brake drum is significantly partially worn, polish or replace it.

2. INSPECT THE SHOE LINING THICKNESS.

- (1) Using vernier calipers, measure the shoe lining thickness.

Permissible limit (mm {in.})	1.5 {0.059}
In the case of a new product (mm {in.})	3.6 {0.142}

- (2) If the shoe lining thickness is below the limit, or if the brake shoe is significantly partially worn, replace the brake shoe.

3. REMOVE ABNORMAL CONTACT BETWEEN THE BRAKE DRUM AND BRAKE LINING.

- (1) Apply chalk inside the brake drum, and rub it with the brake shoe.

STANDARD

There should be no significant defective contact.

- (2) If there is any significant defective contact, replace the brake shoe or polish the brake drum.

⚠ CAUTION

After inspection, wipe off the chalk.

**ASSEMBLING THE PARKING BRAKE DRUM
(PARKING DRUM INNER DIAMETER: 177.8 mm
(7.000 in.))**

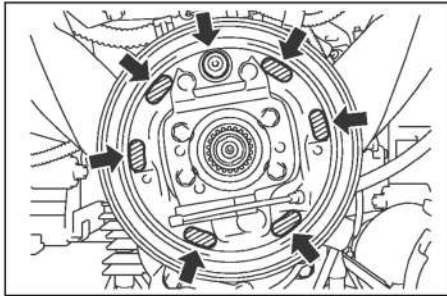

SHTS09ZZ1800183

1. APPLY GREASE.

- (1) Apply a thin coat of heat-resistant grease (Darina Grease 2 or equivalent) to the contact surface of the backing plate and brake shoe, the contact surface of the parking brake shoe adjuster and brake shoe, and the contact surface of the parking brake shoe strut and brake shoe.

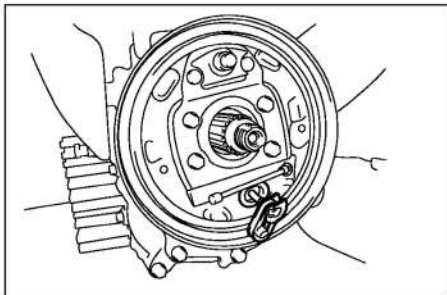

SHTS09ZZ1800184

2. INSTALL THE PARKING BRAKE SHOE ADJUSTER ASSEMBLY.

- (1) Install the parking brake shoe adjuster.

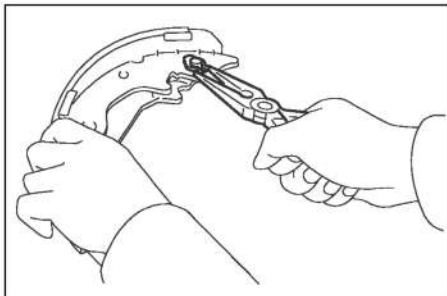

SHTS09ZZ1800185

3. INSTALL THE PARKING BRAKE SHOE LEVER ASSEMBLY.

- (1) Install the parking brake shoe lever to parking brake shoe No.1 along with a new C-washer.

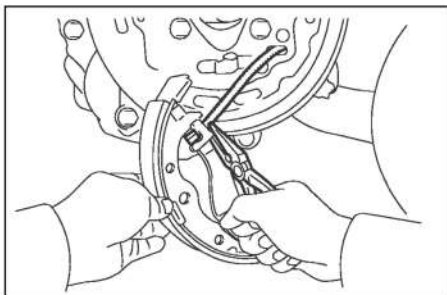

SHTS09ZZ1800186

4. INSTALL PARKING BRAKE SHOE NO.1.

- (1) Using needle-nose pliers, install parking brake cable No.3 to the parking brake lever.

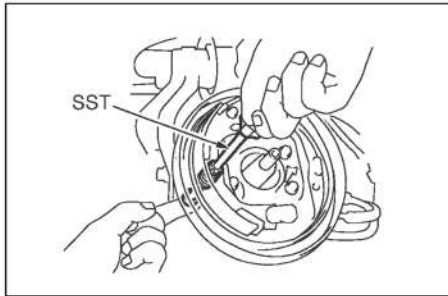

SHTS09ZZZ1800187

- (2) Using SST, install the parking brake shoe hold-down spring, parking brake shoe hold-down cups (2 pcs.), and parking brake shoe hold-down spring pin to parking brake shoe No. 1.

SST: 09718-00011

Shoe hold-down spring driver

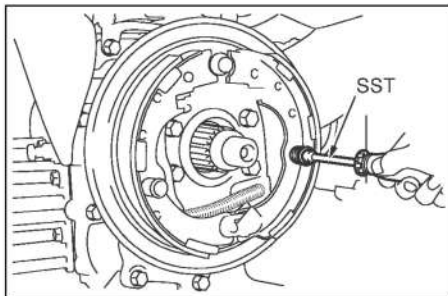

SHTS09ZZZ1800188

5. INSTALL PARKING BRAKE SHOE NO.2.

- (1) Install parking brake shoe No.2.
(2) Using SST, install the parking brake shoe hold-down spring, parking brake shoe hold-down cups (2 pcs.), and shoe hold-down spring pin to parking brake shoe No.2.

SST: 09718-00011

Shoe hold-down spring driver

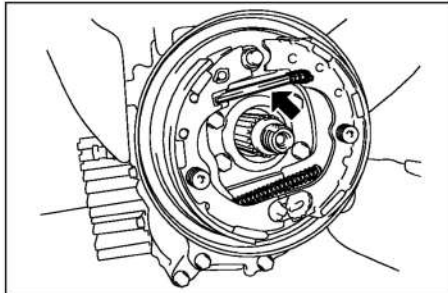

SHTS09ZZZ1800189

- (3) Install the parking brake shoe lever strut and parking brake shoe strut compression spring.

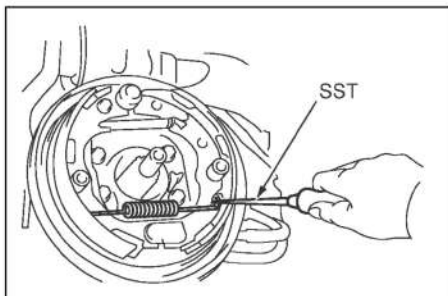

SHTS09ZZZ1800190

6. INSTALL PARKING BRAKE SHOE RETURN TENSION SPRING NO.2.

- (1) Using SST, install parking brake shoe return tension spring No.2.

SST: 09921-00011

Spring tension tool

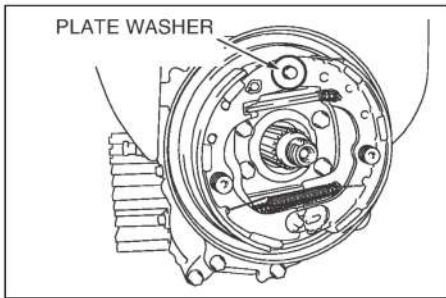

SHTS09ZZZ1800191

7. INSTALL PARKING BRAKE SHOE RETURN TENSION SPRING NO.1.

(1) Install the plate washer.

(2) Using SST, install parking brake shoe return tension springs No.1 (2 pcs.) as shown in the figure.

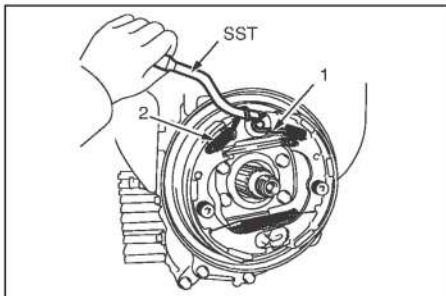

SHTS09ZZZ1800192

NOTICE

Install the first parking brake shoe return tension spring No.1 on the right side.

**SST: 09718-20010
Brake shoe return spring replacer**

8. INSPECT THE INSTALLATION OF THE PARKING BRAKE.

(1) Make sure that all parts are properly installed.

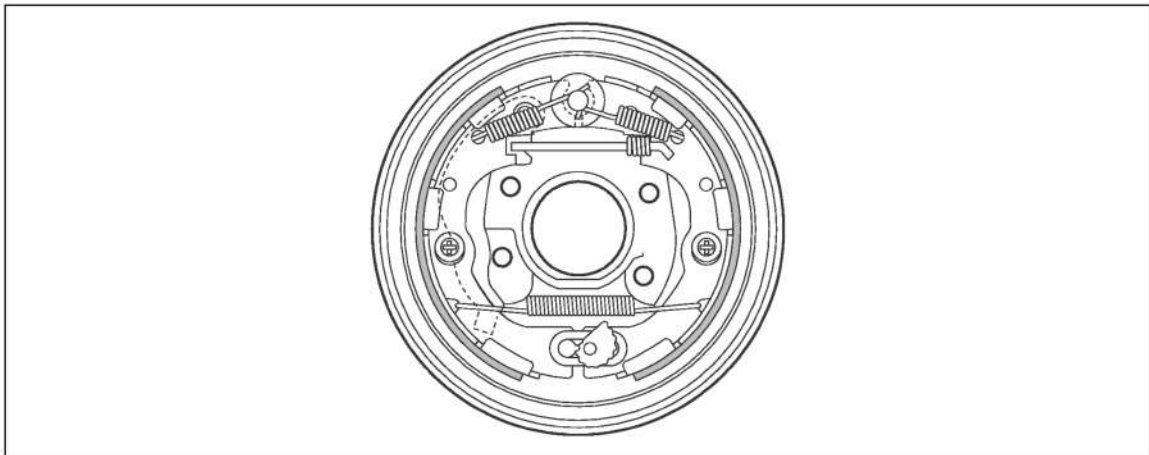

SHTS09ZZZ1800193

9. INSTALL THE PARKING BRAKE DRUM.

(1) Turn the parking brake shoe adjuster all the way clockwise to reduce the brake shoe expansion.
(2) Install the parking brake drum.

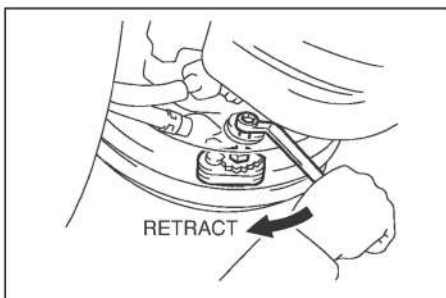

SHTS09ZZZ1800194

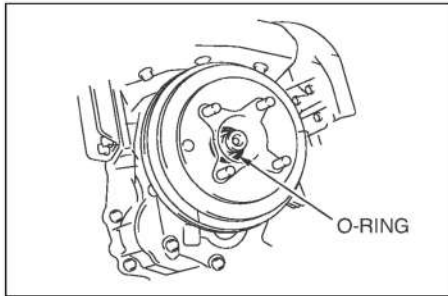

SHTS09ZZZ1800195

- (3) Apply Brake grease to a new O-ring and attach it to the drum.

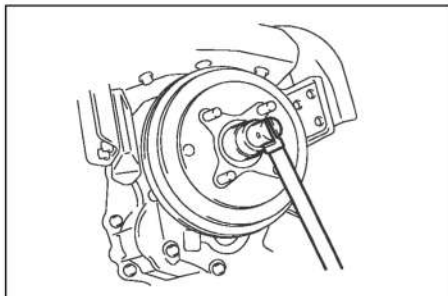

SHTS09ZZZ1800196

- (4) Using a socket wrench (32 mm (1.260 in.)), tighten a new output shaft set nut.

Tightening Torque:
127 N·m {1,295 kgf·cm, 95 lbf·ft}
Transmission M/T
190 N·m {1,937 kgf·cm, 140 lbf·ft}
Transmission A/T

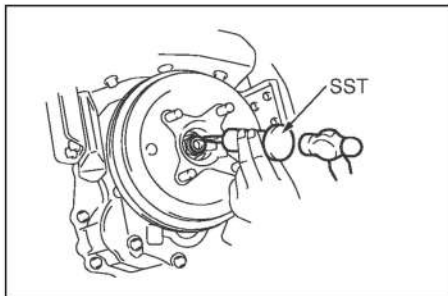

SHTS09ZZZ1800197

- (5) Using SST and a hammer, stake the output shaft set nut.

SST: 09930-00010
Drive shaft nut chisel

⚠ CAUTION

- Stake the output shaft set nut securely.
- When staking the nut, pay attention not to strike it in such a direction that the nut will loosen.

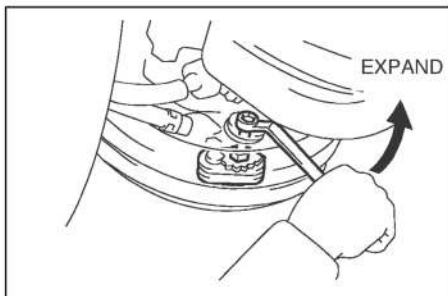

SHTS09ZZZ1800198

10. ADJUST A PARKING BRAKE SHOE CLEARANCE.

- (1) Turn the parking brake shoe adjuster all the way counter-clockwise, make sure that the brake drum is locked, then turn the adjuster clockwise one notch.
- (2) Pull the parking brake lever all the way, then check to see if the brake drum is completely locked.
- (3) Lower the parking brake lever again, then make sure that the brake drum does not cause brake dragging.

NOTICE

If brake dragging is observed, turn the adjuster clockwise another notch.

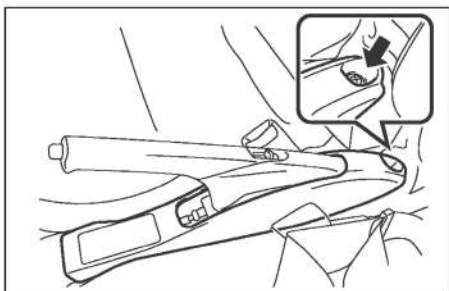

SHTS09ZZZ1800199

- 11. INSTALL THE PARKING BRAKE HOLE COVER.**
 - (1) Install the parking brake hole cover with a screw.
- 12. ADJUST THE PARKING BRAKE LEVER RESERVE TRAVEL.**
Reference: BRAKE, PARKING BRAKE, PARKING BRAKE, INSPECTION AND ADJUSTMENT, PARKING BRAKE ADJUSTMENT (Page 9-259)
- 13. INSTALL THE PARKING BRAKE HOLE COVER.**
 - (1) Install the parking brake hole cover with a screw.
- 14. INSTALL THE PROPELLER SHAFT.**
Reference: PROPELLER SHAFT (LE), PROPELLER SHAFT MECHANICAL, PROPELLER SHAFT ASSEMBLY, OVERHAUL, INSTALLING THE PROPELLER SHAFT ASSEMBLY (Page 6-12)

**DISASSEMBLING THE PARKING BRAKE DRUM
(PARKING DRUM INNER DIAMETER: 190 mm (7.480 in.))**

1. REMOVE THE PROPELLER SHAFT.

Reference: PROPELLER SHAFT (LE), PROPELLER SHAFT MECHANICAL, PROPELLER SHAFT ASSEMBLY, OVERHAUL, REMOVING THE PROPELLER SHAFT ASSEMBLY (Page 6-7)

2. REMOVE THE PARKING BRAKE HOLE COVER.

- (1) Unfasten the screw and remove the parking brake hole cover.

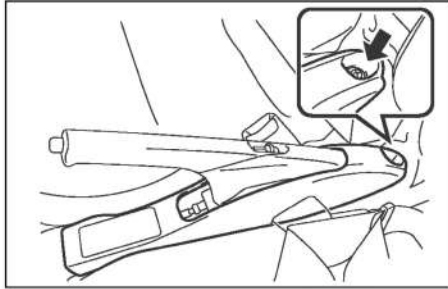

SHTS09ZZZ1800200

3. REMOVE THE PARKING BRAKE DRUM.

- (1) Loosen the lock nut and make some slack on parking brake cable No.2.

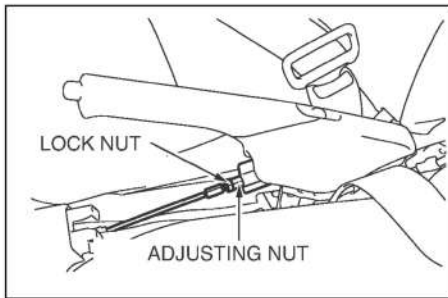

SHTS09ZZZ1800201

- (2) Unfasten the bolt and remove the parking brake dust cover.
- (3) Remove the parking brake drum.
- (4) If the parking brake drum cannot be removed easily, take the steps as instructed below.
 - a. Align the adjustment hole on the parking brake drum with the position of the parking brake shoe adjusting screw set.

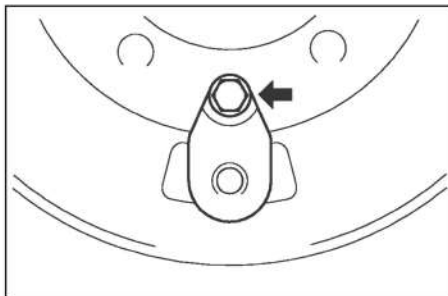

SHTS09ZZZ1800202

- b. Using a flathead driver, turn the parking brake shoe adjusting screw set to reduce the parking brake shoe expansion.

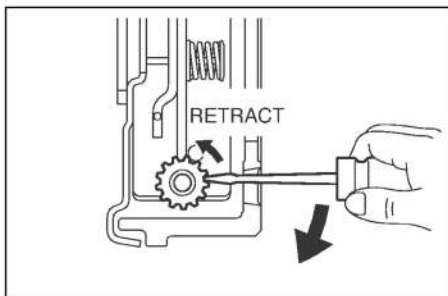

SHTS09ZZZ1800203

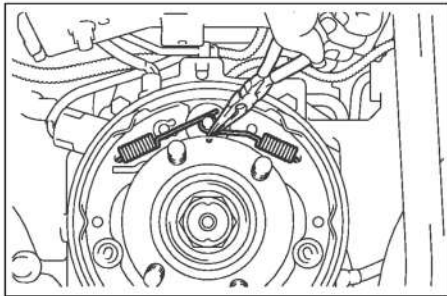

SHTS09ZZZ1800204

4. REMOVE PARKING BRAKE SHOE RETURN TENSION SPRINGS NO.1.

- (1) Using needle-nose pliers, remove parking brake shoe return tension springs No.1 (2 pcs.) and washers.

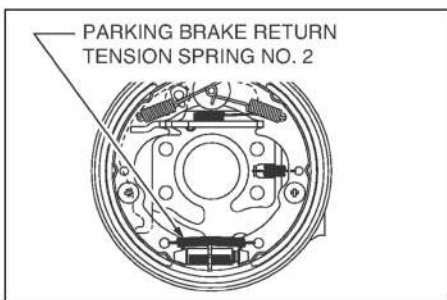

SHTS09ZZZ1800205

5. REMOVE THE RH PARKING BRAKE SHOE ADJUSTING SCREW SET.

- (1) Using needle-nose pliers, remove parking brake shoe return tension spring No.2.

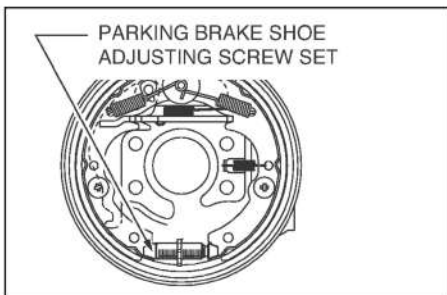

SHTS09ZZZ1800206

- (2) Remove the parking brake shoe adjusting screw set.

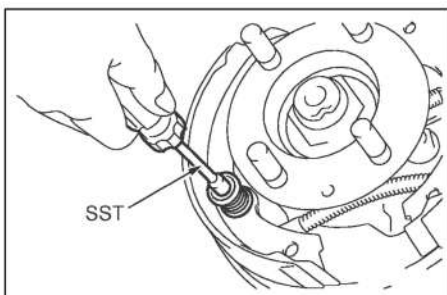

SHTS09ZZZ1800207

6. REMOVE PARKING BRAKE SHOE NO.1.

- (1) Using SST, remove the parking brake shoe hold-down cups (2 pcs.), parking brake shoe hold-down spring, and parking brake shoe hold-down spring pin.

SST: 09718-00011

Shoe hold-down spring driver

- (2) Disconnect parking brake cable No.3 from the parking brake shoe lever, then remove parking brake shoe No.1.

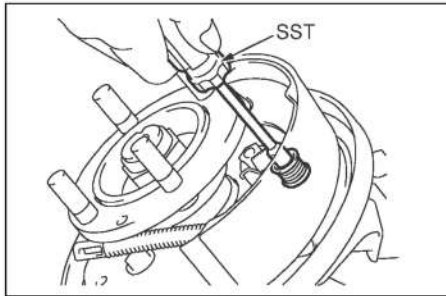

SHTS09ZZZ1800208

7. REMOVE PARKING BRAKE SHOE NO.2.

- (1) Using SST, remove the parking brake shoe hold-down cups (2 pcs.), parking brake shoe hold-down spring, and parking brake shoe hold-down spring pin.

SST: 09718-00011

Shoe hold-down spring driver

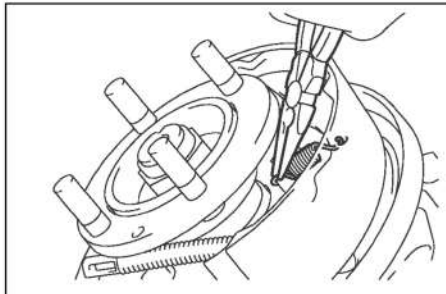

SHTS09ZZZ1800209

- (2) Move parking brake shoe No.2 to the right, then using needle-nose pliers, remove parking brake shoe return tension spring No.3, then remove parking brake shoe No.2.

- (3) Remove the parking brake shoe lever strut, parking shoe strut, and parking brake shoe strut compression spring from parking brake shoe No.2.

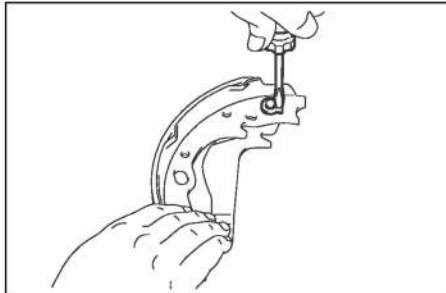

SHTS09ZZZ1800210

8. REMOVE THE PARKING BRAKE SHOE LEVER ASSEMBLY.

- (1) Using the flathead driver, remove the parking brake shoe C-washer, then remove the parking brake shoe lever.

INSPECTING THE PARKING BRAKE DRUM (PARKING DRUM INNER DIAMETER: 190 mm (7.480 in.))

1. INSPECT THE THICKNESS OF THE PARKING BRAKE SHOE LINING.

- (1) Inspect the thickness of the parking brake shoe lining.

Permissible limit (mm {in.})	1.0 {0.039}
In the case of a new product (mm {in.})	4.0 {0.157}

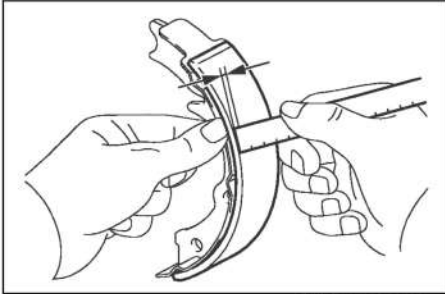

SHTS09ZZZ1800211

⚠ CAUTION

If it requires replacement, replace both left and right sides at the same time. (This is to prevent the vehicle from being pulled to one side when braking.)

2. INSPECT THE CONTACT BETWEEN THE BRAKE DRUM AND LINING.

- (1) Apply chalk inside the brake drum, and rub it with the parking brake shoe.

STANDARD

There should be no significant defective contact.

- (2) If there is any defective contact, polish the parking brake shoe lining.

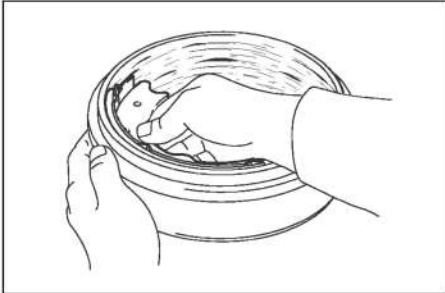

SHTS09ZZZ1800212

⚠ CAUTION

After inspection, wipe off the chalk.

3. INSPECT THE BRAKE DRUM FOR WEAR AND DAMAGE.

- (1) Using vernier calipers, measure the inner diameter of the brake drum.

Permissible limit (mm {in.})	191 {7.520}
In the case of a new product (mm {in.})	190 {7.480}

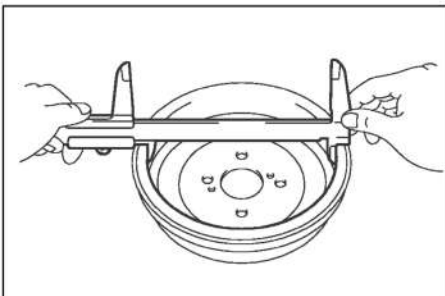

SHTS09ZZZ1800213

- (2) If the brake drum is significantly partially worn, polish or replace it.

**ASSEMBLING THE PARKING BRAKE DRUM
(PARKING DRUM INNER DIAMETER: 190 mm (7.480 in.))**

1. INSTALL THE PARKING BRAKE SHOE LEVER ASSEMBLY.

- (1) Install the parking brake shoe lever to parking brake shoe No.1 along with a new parking brake shoe C-washer.
- (2) Using pliers, stake the parking brake shoe C-washer.
- (3) Make sure that the parking brake shoe lever moves smoothly.

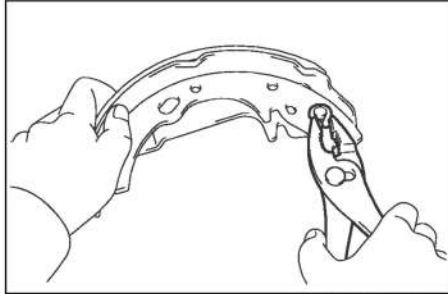

SHTS09ZZZ1800214

2. APPLY GREASE.

- (1) Apply a thin coat of heat-resistant grease to the contact surface of the parking brake plate and parking brake shoe, and the contact surface of the anchor and parking brake shoe.

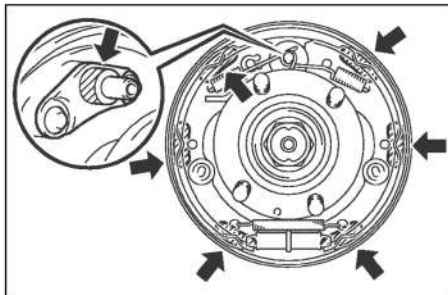

SHTS09ZZZ1800215

3. INSTALL PARKING BRAKE SHOE NO.2.

- (1) Install the parking brake shoe lever strut and parking brake shoe strut compression spring to parking brake shoe No.2.
- (2) Using needle-nose pliers, install parking brake shoe return tension spring No.3.

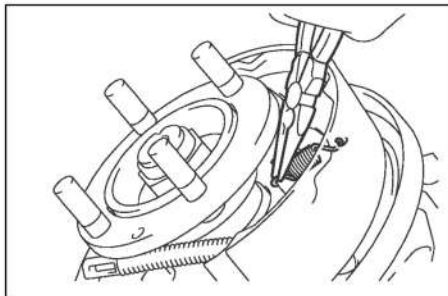

SHTS09ZZZ1800216

- (3) Using SST, install parking brake shoe No.2 with the parking brake shoe hold-down cups (2 pcs.), parking brake shoe hold-down spring, and parking brake shoe hold-down spring pin.

**SST: 09718-00011
Shoe hold-down spring driver**

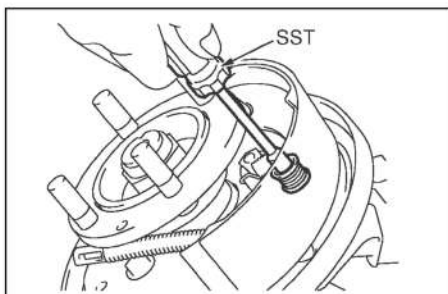

SHTS09ZZZ1800217

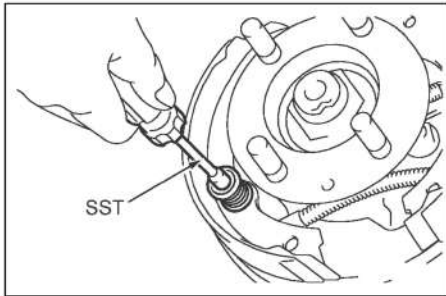

SHTS09ZZ1800218

4. INSTALL PARKING BRAKE SHOE NO.1.

- (1) Connect parking brake cable No.3 to the parking brake shoe lever.
- (2) Using SST, install parking brake shoe No.1 with the parking brake shoe hold-down cups (2 pcs.), parking brake shoe hold-down spring, and parking brake shoe hold-down spring pin.

SST: 09718-00011

Shoe hold-down spring driver

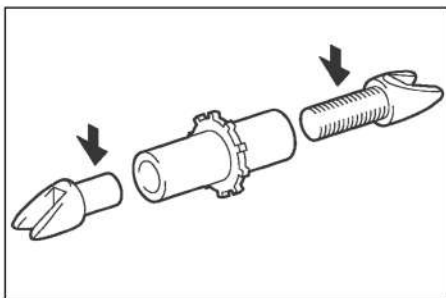

SHTS09ZZ1800219

5. INSTALL THE SHOE ADJUSTING SCREW SET.

- (1) Apply heat-resistant grease to the area around the arrows on the parking brake shoe adjusting screw set.

- (2) Install the parking brake shoe adjusting screw set.

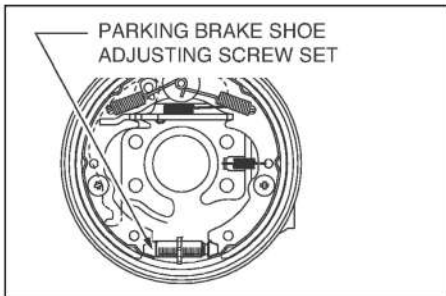

SHTS09ZZ1800220

- (3) Using needle-nose pliers, install parking brake shoe return tension spring No.2.

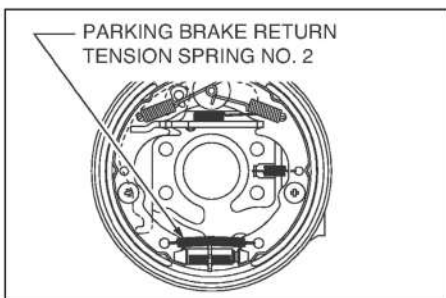

SHTS09ZZ1800221

Update Date : 2019-09-12 Print Date : 2020-02-27

9-342

BRAKE/PARKING BRAKE

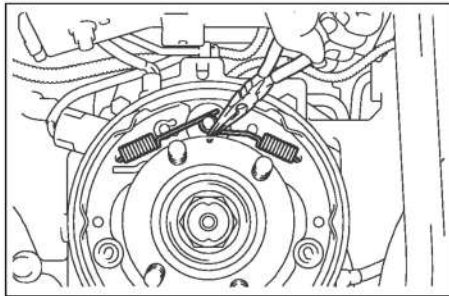

SHTS09ZZZ1800222

6. INSTALL PARKING BRAKE SHOE RETURN TENSION SPRING NO.1.

- (1) Using needle-nose pliers, install parking shoe return tension springs No.1 (2 pcs.).

7. INSPECT THE INSTALLATION OF THE PARKING BRAKE.

- (1) Make sure that all parts are properly installed.

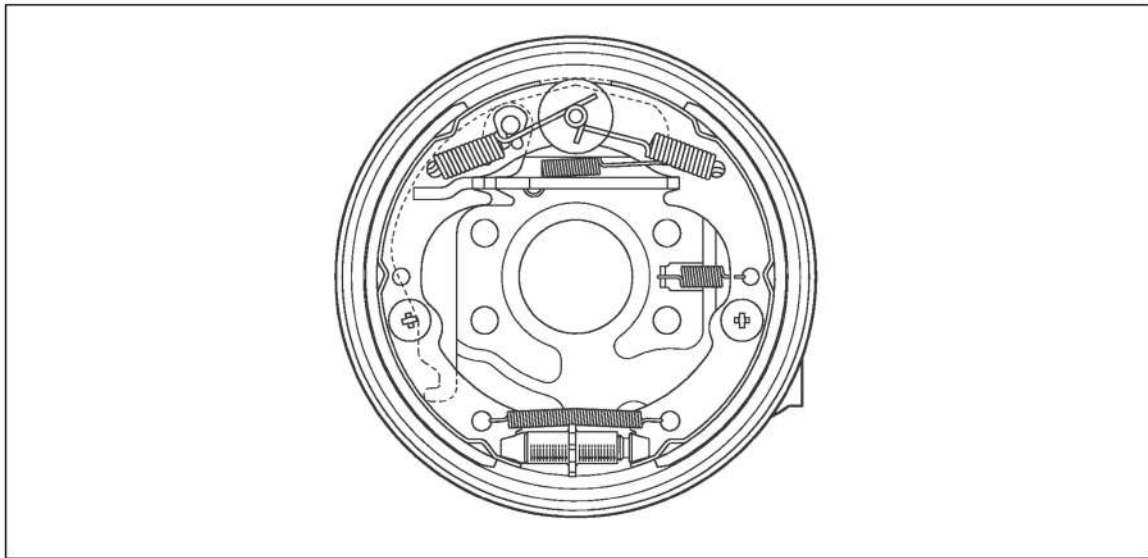

SHTS09ZZZ1800223

⚠ CAUTION

Make sure that the surface of the shoe lining is free from oil or water.

8. INSTALL THE PARKING BRAKE DRUM.

- (1) Install the parking brake drum.

9. ADJUST A CLEARANCE BETWEEN THE BRAKE DRUM AND LINING.

- (1) Align the adjustment hole on the parking brake drum with the position of the parking brake shoe adjusting screw set.
- (2) Using a flathead driver, turn the parking brake shoe adjusting screw set in the direction of "shoe expansion" so that the parking brake shoe will be completely in contact with the drum.
- (3) Turn the parking brake shoe adjusting screw set in the opposite direction by 30 notches.
- (4) Make sure that there is no brake dragging.

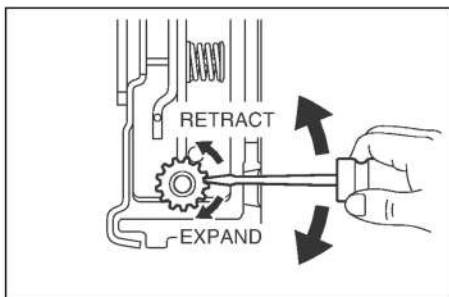

SHTS09ZZZ1800224

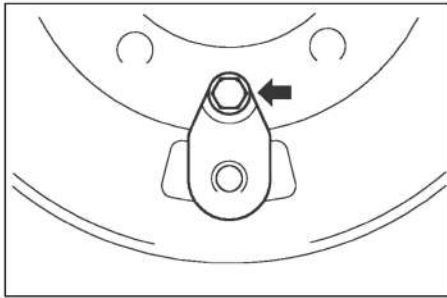

SHTS09ZZ1800225

(5) Install the parking brake dust cover using the bolt.

Tightening Torque:
8.2 N·m {84 kgf·cm, 6.0 lbf·ft}

10. ADJUST THE PARKING BRAKE LEVER RESERVE TRAVEL.
Reference: BRAKE, PARKING BRAKE, PARKING BRAKE, INSPECTION AND ADJUSTMENT, PARKING BRAKE ADJUSTMENT (Page 9-259)

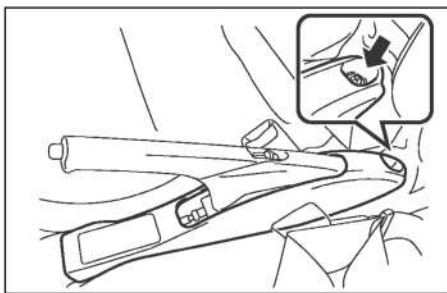

SHTS09ZZ1800226

11. INSTALL THE PARKING BRAKE HOLE COVER.

(1) Install the parking brake hole cover with a screw.

12. INSTALL THE PROPELLER SHAFT.
Reference: PROPELLER SHAFT (LE), PROPELLER SHAFT MECHANICAL, PROPELLER SHAFT ASSEMBLY, OVERHAUL, INSTALLING THE PROPELLER SHAFT ASSEMBLY (Page 6-12)

**DISASSEMBLING THE PARKING BRAKE DRUM
(PARKING DRUM INNER DIAMETER: 200 mm (7.874 in.))**

1. REMOVE THE PROPELLER SHAFT.

Reference: PROPELLER SHAFT (LE), PROPELLER SHAFT MECHANICAL, PROPELLER SHAFT ASSEMBLY, OVERHAUL, REMOVING THE PROPELLER SHAFT ASSEMBLY (Page 6-7)

2. REMOVE THE PARKING BRAKE HOLE COVER.

- (1) Unfasten the screw and remove the parking brake hole cover.

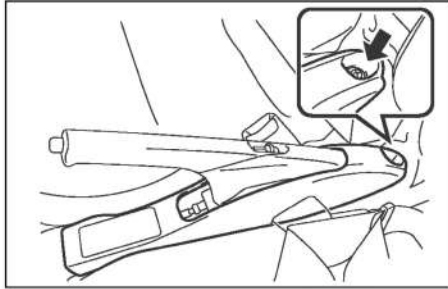

SHTS09ZZZ1800227

3. REMOVE THE PARKING BRAKE DRUM.

- (1) Pull the parking brake lever.
- (2) Using SST and a hammer, remove the staked portion of the output shaft set nut.

SST: 09930-00010
Drive shaft nut chisel

⚠ CAUTION

- Use SST with its tapered side facing toward the shaft.
- Do not grind the tip of SST with a grinder.

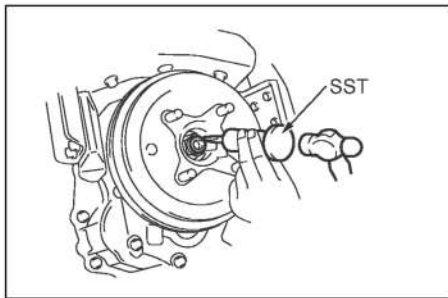

SHTS09ZZZ1800228

- (3) Using a socket wrench (32 mm (1.260 in.)), remove the output shaft set nut.

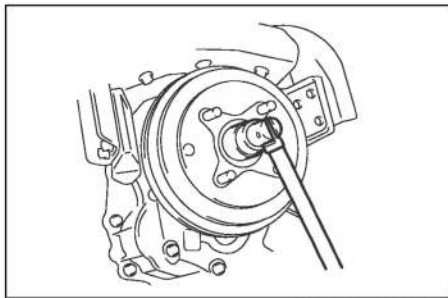

SHTS09ZZZ1800229

- (4) Using the flathead driver, remove the O-ring.

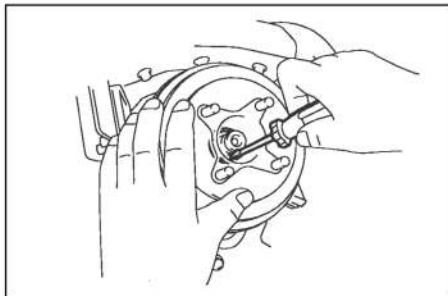

SHTS09ZZZ1800230

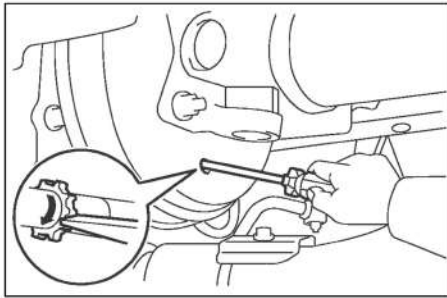

SHTS09ZZ1800231

- (5) Lower the parking brake lever and remove the parking brake drum.

NOTICE

If the brake drum cannot be removed easily, remove the rubber plug, then turn the shoe adjuster in the direction of the arrow to reduce the shoe expansion.

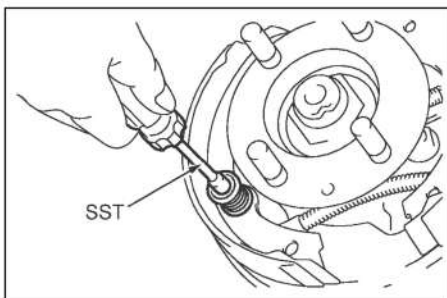

SHTS09ZZ1800232

- (6) Loosen the lock nut and make some slack on parking brake cable No.2.

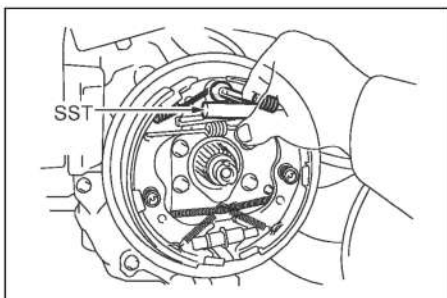

SHTS09ZZ1800233

4. REMOVE THE TENSION SPRINGS.

- (1) Using SST, remove the tension springs (2 pcs.).
SST: **09717-20010**
Brake shoe return spring remover

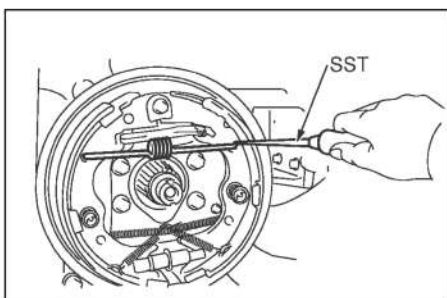

SHTS09ZZ1800234

5. REMOVE PARKING BRAKE SHOE RETURN TENSION SPRINGS NO.2.

- (1) Using SST, remove parking brake shoe return tension spring No.2.
SST: **09921-00011**
Spring tension tool

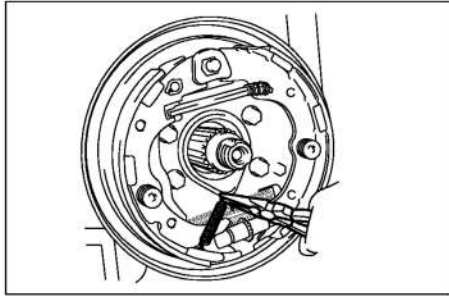

SHTS09ZZZ1800235

6. REMOVE PARKING BRAKE SHOE RETURN TENSION SPRINGS NO.1

- (1) Using needle-nose pliers, remove parking brake shoe return tension springs No.1 (2 pcs.).

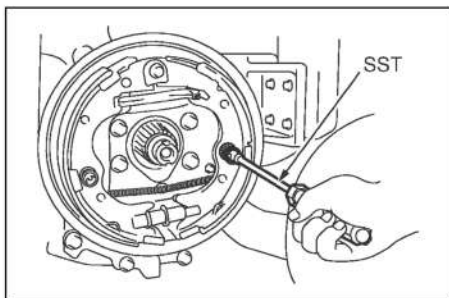

SHTS09ZZZ1800236

7. REMOVE PARKING BRAKE SHOE NO.2.

- (1) Using SST, remove the parking brake shoe hold-down spring, parking brake shoe hold-down spring cup, parking brake shoe hold-down spring pin, and parking brake shoe No.2.

SST: 09718-00011
Shoe hold-down spring driver

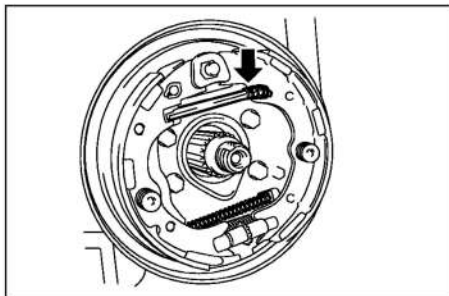

SHTS09ZZZ1800237

- (2) Remove the parking brake shoe lever strut and parking brake shoe strut compression spring.

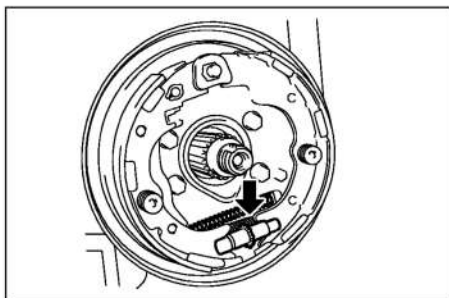

SHTS09ZZZ1800238

- (3) Remove the parking brake shoe adjusting screw set.
- (4) Remove parking brake shoe No.2.
- (5) Remove parking shoe return tension spring No.2.

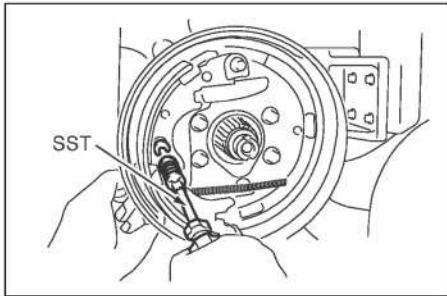

SHTS09ZZZ1800239

8. REMOVE PARKING BRAKE SHOE NO.1.

- (1) Using SST, remove the parking brake shoe hold-down spring, parking brake shoe hold-down spring cups (2 pcs.), parking brake shoe hold-down spring pin, and parking brake shoe No.1.

SST: 09718-00011

Shoe hold-down spring driver

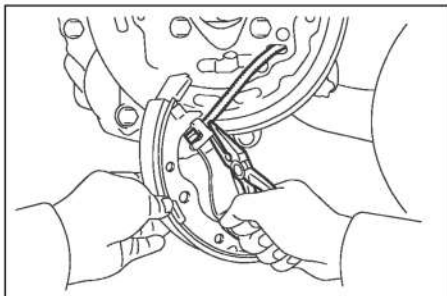

SHTS09ZZZ1800240

- (2) Using needle-nose pliers, remove parking brake shoe No.1 from the parking brake shoe lever.

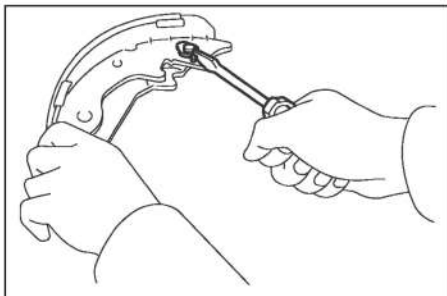

SHTS09ZZZ1800241

- (3) Using the flathead driver, remove the C-washer, then remove the parking brake shoe lever from parking brake shoe No.1.

9. REMOVE THE PARKING BRAKE SHOE GUIDE PLATE.

- (1) Unfasten the bolt and remove the parking brake shoe guide plate.

Update Date : 2019-09-12 Print Date : 2020-02-27

9-348

BRAKE/PARKING BRAKE

INSPECTING THE PARKING BRAKE DRUM (PARKING DRUM INNER DIAMETER: 200 mm (7.874 in.))

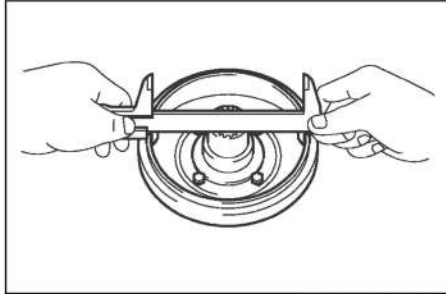

SHTS09ZZZ1800242

1. INSPECT THE BRAKE DRUM FOR WEAR AND DAMAGE.

- (1) Using vernier calipers, measure the inner diameter of the brake drum.

Permissible limit (mm {in.})	201 {7.913}
In the case of a new product (mm {in.})	200 {7.874}

- (2) If the brake drum is significantly partially worn, polish or replace it.

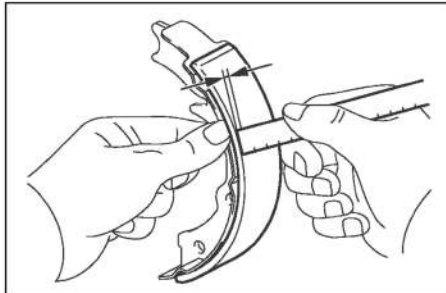

SHTS09ZZZ1800243

2. INSPECT THE SHOE LINING THICKNESS.

- (1) Using vernier calipers, measure the shoe lining thickness.

Permissible limit (mm {in.})	1.5 {0.059}
In the case of a new product (mm {in.})	3.8 {0.150}

- (2) If the shoe lining thickness is below the limit, or if the brake shoe is significantly partially worn, replace the brake shoe.

3. INSPECT THE CONTACT BETWEEN THE BRAKE DRUM AND LINING.

- (1) Apply chalk inside the brake drum, and rub it with the brake shoe.

STANDARD

There should be no significant defective contact.

- (2) If there is any significant defective contact, replace the brake shoe or polish the brake drum.

⚠ CAUTION

After inspection, wipe off the chalk.

**ASSEMBLING THE PARKING BRAKE DRUM
(PARKING DRUM INNER DIAMETER: 200 mm (7.874 in.))**

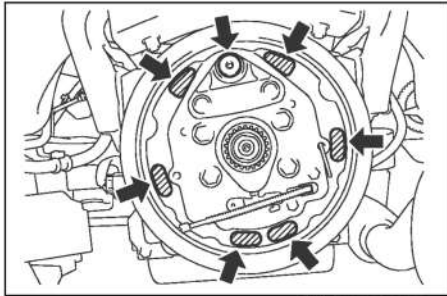

SHTS09ZZZ1800244

1. APPLY GREASE.

- (1) Apply a thin coat of heat-resistant grease (Darina Grease 2 or equivalent) to the contact surface of the backing plate and brake shoe, the contact surface of the anchor plate and brake shoe, the parking brake shoe adjusting screw area, and the contact surface of the parking brake shoe strut and brake shoe.

2. INSTALL THE PARKING BRAKE SHOE GUIDE PLATE.

- (1) Install the parking brake shoe guide plate with the bolts.

**Tightening Torque:
18 N·m {184 kgf·cm}**

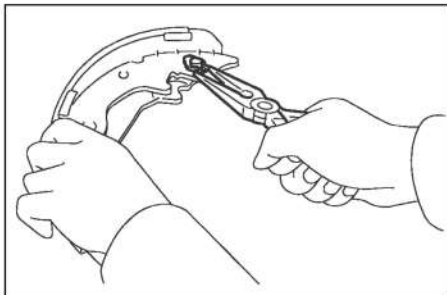

SHTS09ZZZ1800245

3. INSTALL PARKING BRAKE SHOE NO.1.

- (1) Install the parking brake shoe lever to parking brake shoe No.1 along with a new C-washer.

- (2) Using needle-nose pliers, install parking brake cable No.3 to the parking brake shoe lever.

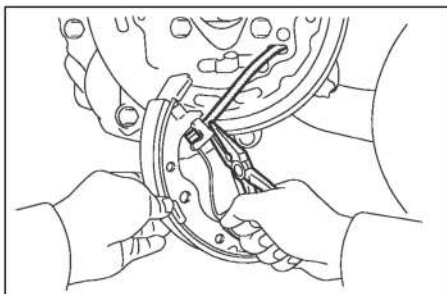

SHTS09ZZZ1800246

- (3) Using SST, install parking brake shoe No.1 with the parking brake shoe hold-down spring, parking brake shoe hold-down spring cups (2 pcs.), and parking brake shoe hold-down spring pin to the backing plate.

**SST: 09718-00011
Shoe hold-down spring driver**

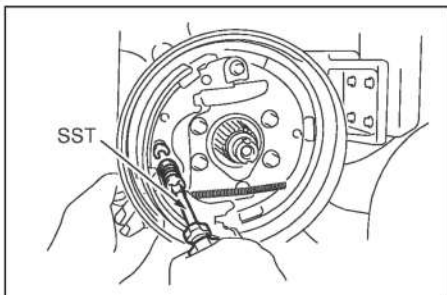

SHTS09ZZZ1800247

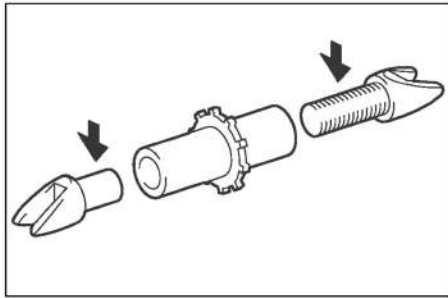

SHTS09ZZZ1800248

4. INSTALL THE SHOE ADJUSTING SCREW SET.

- (1) Apply a thin coat of heat-resistant grease (Darina Grease 2 or equivalent) to the screw part on the parking brake shoe adjusting screw set.

- (2) Install the parking brake shoe adjusting screw set.

NOTICE

Minimize the length of the parking brake shoe adjusting screw set for installation of the parking brake drum.

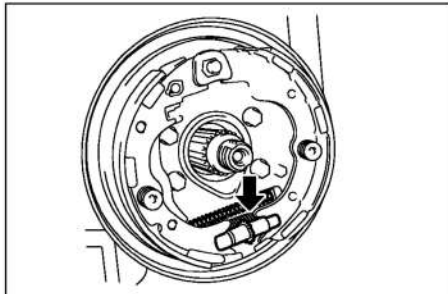

SHTS09ZZZ1800249

5. INSTALL THE PARKING BRAKE SHOE LEVER STRUT.

- (1) Install the parking brake shoe lever strut and parking brake shoe strut compression spring.

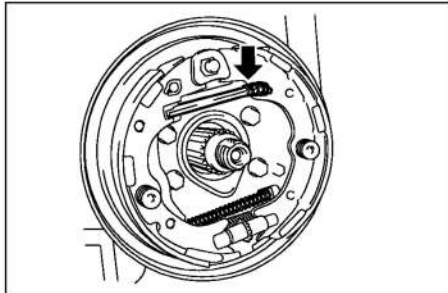

SHTS09ZZZ1800250

6. INSTALL PARKING BRAKE SHOE NO.2.

- (1) Using SST, install parking brake shoe No.2 with the parking brake shoe hold-down spring, parking brake shoe hold-down spring cup, and parking brake shoe hold-down spring pin to the backing plate.

SST: 09718-00011

Shoe hold-down spring driver

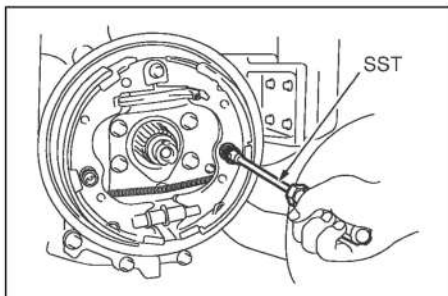

SHTS09ZZZ1800251

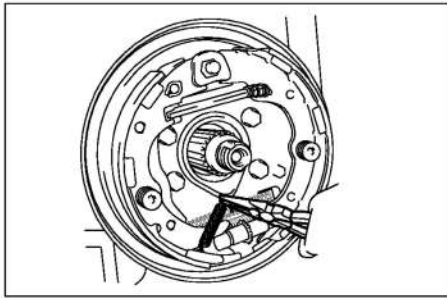

SHTS09ZZ1800252

7. INSTALL PARKING BRAKE SHOE RETURN TENSION SPRINGS NO.1.

- (1) Using needle-nose pliers, install parking brake shoe return tension springs No.1 (2 pcs.).

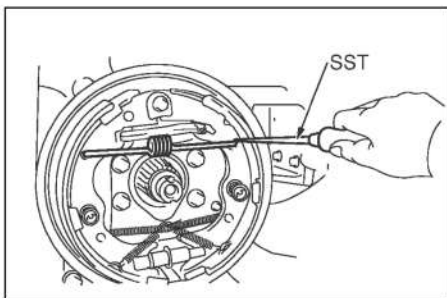

SHTS09ZZ1800253

8. INSTALL PARKING BRAKE SHOE RETURN TENSION SPRING NO.2.

- (1) Using SST, install parking brake shoe return tension spring No.2.
SST: 09921-00011
Spring tension tool

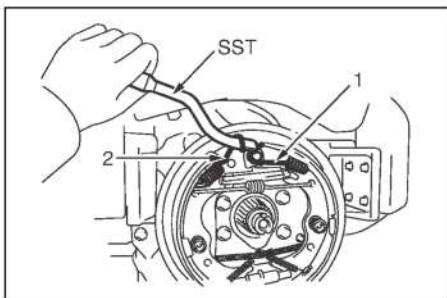

SHTS09ZZ1800254

9. INSTALL THE TENSION SPRINGS.

- (1) Using SST, install the tension springs (2 pcs.) as shown in the figure.
SST: 09718-20010
Brake shoe return spring replacer

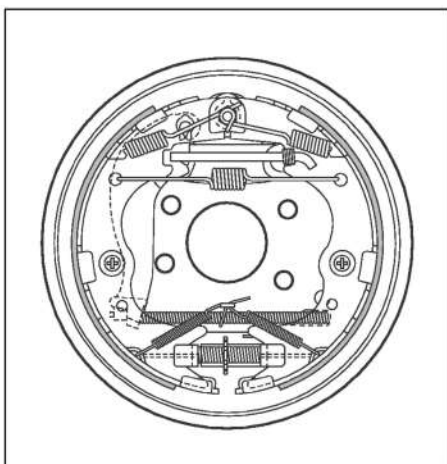

SHTS09ZZ1800255

10. INSPECT THE INSTALLATION OF THE PARKING BRAKE.

- (1) Make sure that all parts are properly installed.

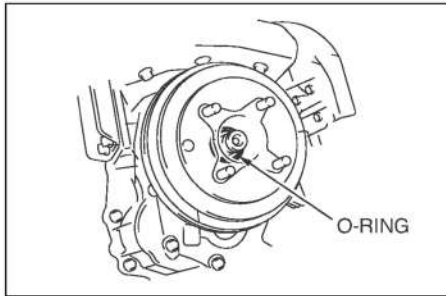

SHTS09ZZZ1800256

11. INSTALL THE PARKING BRAKE DRUM.

- (1) Install the parking brake drum.
- (2) Apply Brake grease to a new O-ring and attach it to the drum.

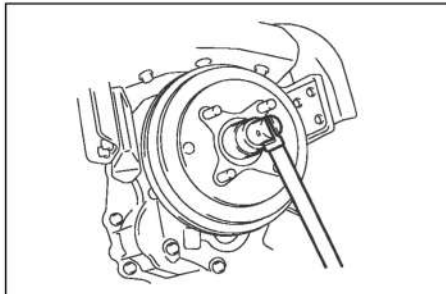

SHTS09ZZZ1800257

- (3) Using a socket wrench (32 mm (1.260 in.)), tighten a new output shaft set nut.

Tightening Torque:
127 N·m {1,295 kgf·cm, 94 lbf·ft}
Transmission M/T
190 N·m {1,937 kgf·cm, 140 lbf·ft}
Transmission A/T

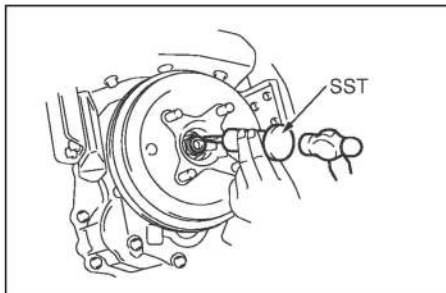

SHTS09ZZZ1800258

- (4) Using SST and a hammer, stake the output shaft set nut.
SST: 09930-00010
Drive shaft nut chisel

⚠ CAUTION

- Stake the output shaft set nut securely.
- When staking the nut, pay attention not to strike it in such a direction that the nut will loosen.

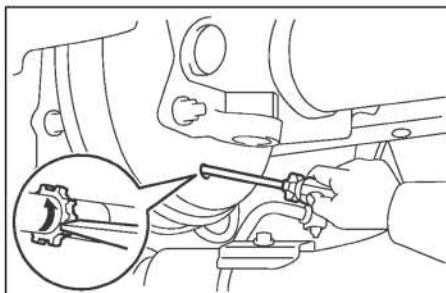

SHTS09ZZZ1800259

12. ADJUST A PARKING BRAKE SHOE CLEARANCE.

- (1) Turn the parking brake drum, align the adjustment hole with the shoe adjuster (at the lower area of the vehicle), then remove the rubber plug.
- (2) Using a flathead driver, turn the shoe adjuster in the direction of the arrow in the figure and make sure that the brake drum is locked.

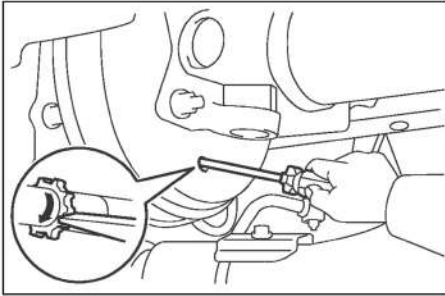

SHTS09ZZZ1800260

- (3) Using the flathead driver, turn the shoe adjuster in the direction of the arrow in the figure by 7 to 10 notches.
- (4) Pull the parking brake lever all the way, then check to see if the brake drum is completely locked.
- (5) Operate the parking brake lever several times, and make sure that there is no brake dragging.

NOTICE

If brake dragging is observed, turn the adjuster clockwise another notch.

- (6) Install the rubber plug into the adjustment hole of the parking brake drum.

CAUTION

If the rubber plug comes off, water may enter the parking brake drum, resulting in early wear of the lining or ineffective braking.

13. ADJUST THE PARKING BRAKE LEVER RESERVE TRAVEL.

Reference: BRAKE, PARKING BRAKE, PARKING BRAKE, INSPECTION AND ADJUSTMENT, PARKING BRAKE ADJUSTMENT (Page 9-259)

14. INSTALL THE PARKING BRAKE HOLE COVER.

- (1) Install the parking brake hole cover with a screw.

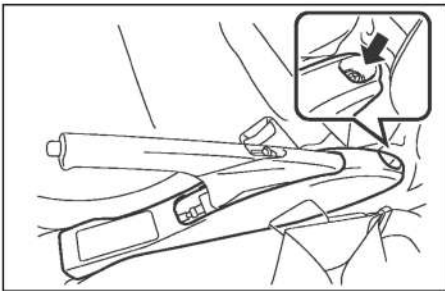

SHTS09ZZZ1800261

15. INSTALL THE PROPELLER SHAFT.

Reference: PROPELLER SHAFT (LE), PROPELLER SHAFT MECHANICAL, PROPELLER SHAFT ASSEMBLY, OVERHAUL, INSTALLING THE PROPELLER SHAFT ASSEMBLY (Page 6-12)

**DISASSEMBLING THE PARKING BRAKE DRUM
(PARKING DRUM INNER DIAMETER: 203.2 mm
(8.000 in.))**

1. **REMOVE THE PROPELLER SHAFT.**
Reference: PROPELLER SHAFT (LD), PROPELLER SHAFT MECHANICAL, PROPELLER SHAFT ASSEMBLY, OVERHAUL, DISASSEMBLING THE PROPELLER SHAFT ASSEMBLY (Page 6-9)
Reference: PROPELLER SHAFT (LE), PROPELLER SHAFT MECHANICAL, PROPELLER SHAFT ASSEMBLY, OVERHAUL, REMOVING THE PROPELLER SHAFT ASSEMBLY (Page 6-7)
2. **REMOVE THE PROPELLER SHAFT ADAPTER (IF SO EQUIPPED)**
 (1) Unfasten the nuts (4pcs.) and remove the propeller shaft adaptor.

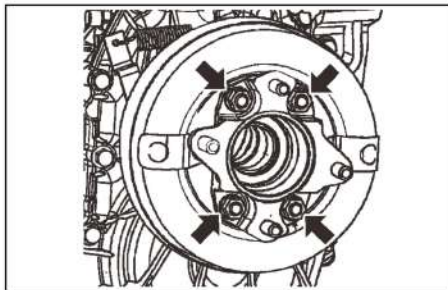

SHTS09ZZZ1800262

3. **REMOVE THE OUTPUT SHAFT LOCK NUT. (MTM).**
 (1) The lock nut has been caulked, so before loosening it, lift the caulked part completely out of the shaft groove.

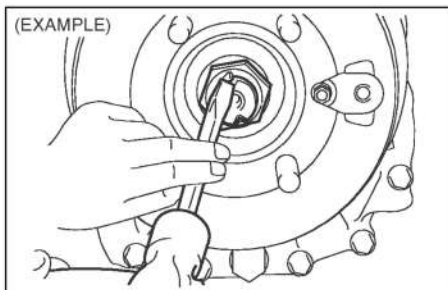

SHTS09ZZZ1800263

- (2) Using the SST or the commercial tool, remove the lock nut.
- NOTICE**
Before loosening the lock nut, engage two gears so that the output shaft can not be turned around.

SST: 09930-00010
Deep Socket Wrench 36

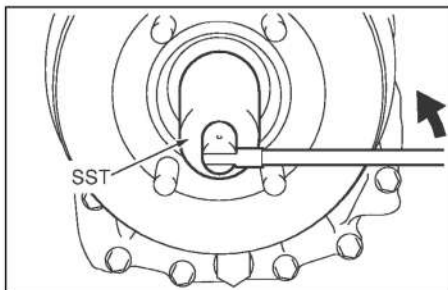

SHTS09ZZZ1800264

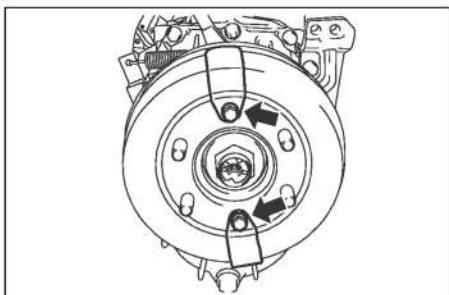

SHTS09ZZ1800265

4. REMOVE THE PARKING BRAKE DRUM.

- (1) Unfasten the bolts (2 pcs.) and remove the parking brake dust covers (2 pcs.) (if so equipped).

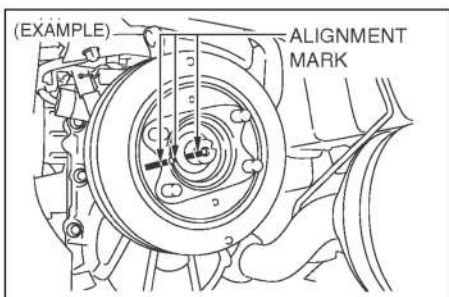

SHTS09ZZ1800266

- (2) Put alignment marks on the parking brake drum, then remove it.

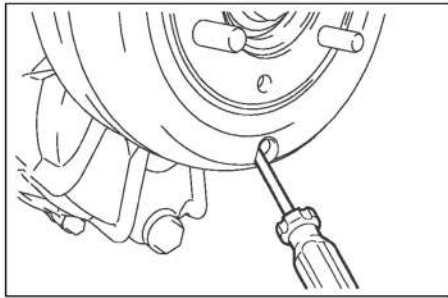

SHTS09ZZZ1800267

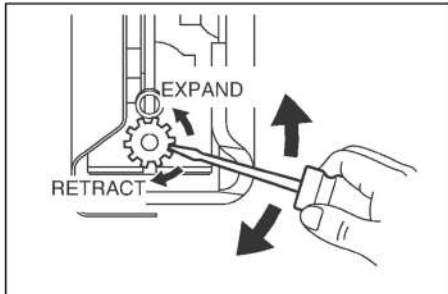

SHTS09ZZZ1800268

(3) If the parking brake drum cannot be removed easily, take the steps as instructed below.

a. Align the adjustment hole on the parking brake drum with the position of the parking brake shoe adjusting screw set.

b. Using a flathead driver, turn the parking brake shoe adjusting screw set to reduce the parking brake shoe expansion.

(4) Remove the parking brake drum and companion flange.

5. DISCONNECT PARKING BRAKE CABLE NO.3.

Reference: BRAKE, PARKING BRAKE, PARKING BRAKE CABLE NO.3, REPLACEMENT, REMOVING THE PARKING BRAKE CABLE NO.3 (PARKING DRUM INNER DIAMETER: 203.2 mm (8.000 in.)) (Page 9-310)

6. REMOVE PARKING BRAKE SHOE RETURN TENSION SPRINGS NO.2.

(1) Using needle-nose pliers, remove parking brake shoe return tension spring No.2.

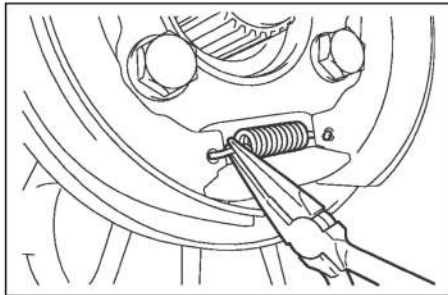

SHTS09ZZZ1800269

7. REMOVE THE SHOE ADJUSTING SCREW SET.

(1) Remove the parking brake shoe adjusting screw set.

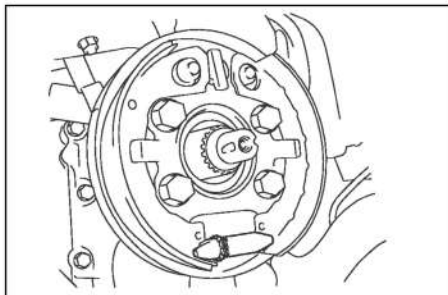

SHTS09ZZZ1800270

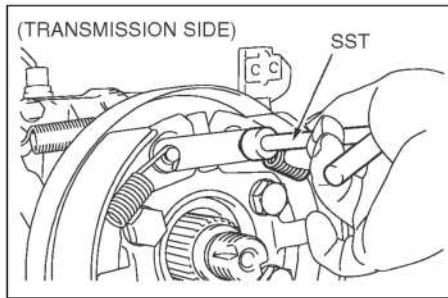

SHTS09ZZ1800271

8. REMOVE PARKING BRAKE SHOE RETURN TENSION SPRINGS NO.1.

- (1) Using SST, remove parking brake shoe return tension springs No.1 (2 pcs.).

SST: 09717-20010

**Brake shoe return spring remover
(Transmission side)**

S0960-61050

**Return spring remover
(Transfer side)**

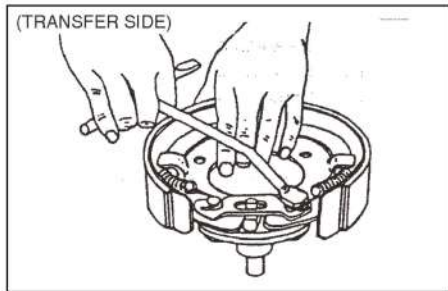

SHTS09ZZ1800272

9. REMOVE THE PARKING BRAKE BRACE (IF SO EQUIPPED).

- (1) Remove the parking brake brace.

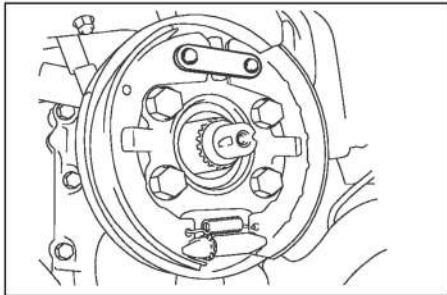

SHTS09ZZ1800273

10. REMOVE THE PARKING BRAKE SUPPORT PLATE.

- (1) Remove the support plate nuts (4 pcs. transmission side) or bolts (4 pcs. transfer side), then remove the parking brake support plate together with the parking brake plate.

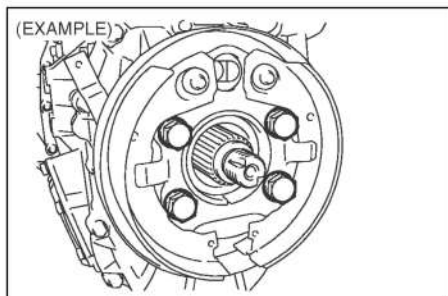

SHTS09ZZ1800274

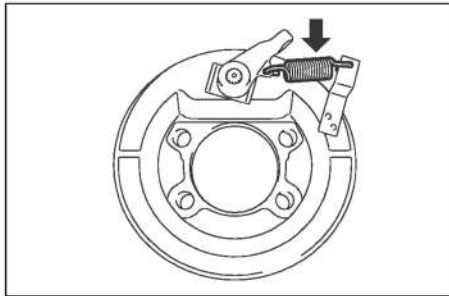

SHTS09ZZZ1800275

- (2) Transmission side
 - a. Remove the parking brake lever spring.

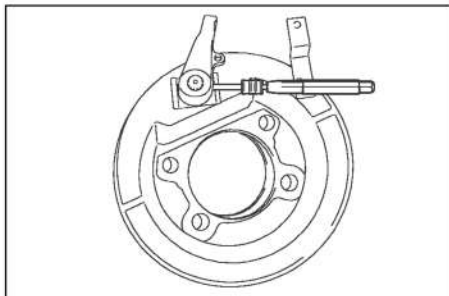

SHTS09ZZZ1800276

- b. Using a pin punch (5 mm (0.197 in.)), remove the parking brake cam lever dowel pin from the parking brake cam lever.

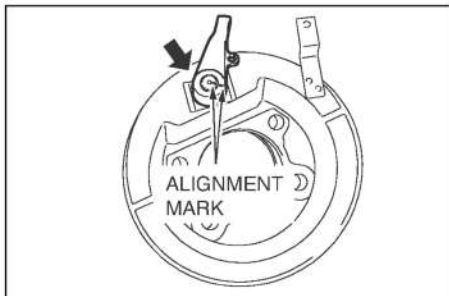

SHTS09ZZZ1800277

- c. Remove Parking brake cam No.1, put alignment marks for the parking brake cam lever, then remove the lever.

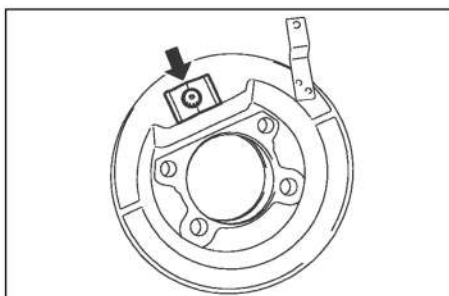

SHTS09ZZZ1800278

- d. Remove the parking brake cam lever spring.

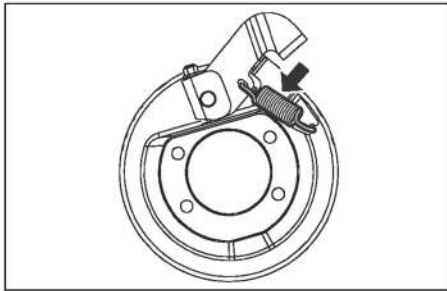

SHTS09ZZZ1800279

- (3) Transfer side
 - a. Remove the parking brake lever spring.

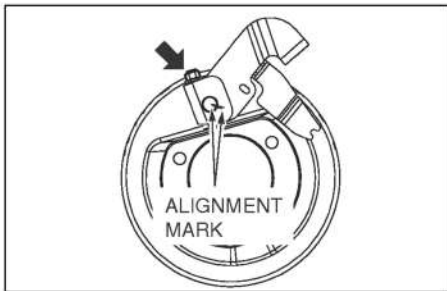

SHTS09ZZZ1800280

- b. Remove nut to remove parking brake cam No.1, put alignment marks for the parking brake cam lever, then remove the lever.

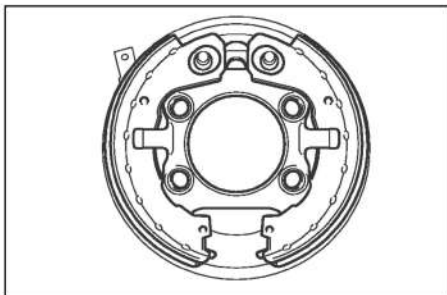

SHTS09ZZZ1800281

- (4) Remove parking brake shoe No.2 and parking brake shoe No.1 together with the parking brake support plate.

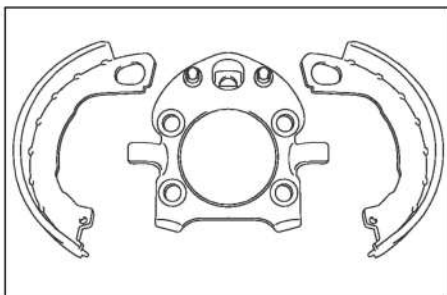

SHTS09ZZZ1800282

- (5) Remove parking brake shoe No.2 and parking brake shoe No.1 from the parking brake support plate.

**INSPECTING THE PARKING BRAKE DRUM
(PARKING DRUM INNER DIAMETER: 203.2 in.)
(8.000 in.)**

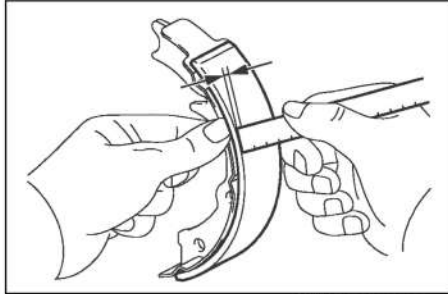

SHTS09ZZZ1800283

1. INSPECT THE THICKNESS OF THE PARKING BRAKE SHOE LINING.

- (1) Using vernier calipers, measure the thickness of the parking brake shoe lining.

Transmission side

Permissible limit (mm {in.})	1.0 {0.039}
In the case of a new product (mm {in.})	3.75 {0.148}

Transfer side

Permissible limit (mm {in.})	1.0 {0.039}
In the case of a new product (mm {in.})	5.0 {0.197}

- (2) If the thickness of the parking brake shoe lining is below the limit, or if the parking brake shoe lining is significantly partially worn, replace it.

⚠ CAUTION

If it requires replacement, replace both left and right sides at the same time. (This is to prevent the vehicle from being pulled to one side when braking.)

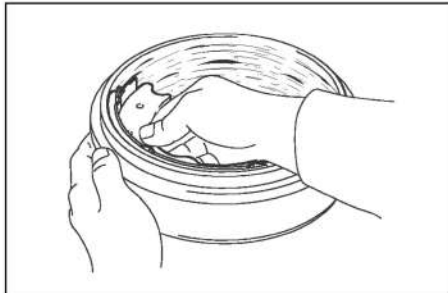

SHTS09ZZZ1800284

2. INSPECT THE CONTACT BETWEEN THE BRAKE DRUM AND LINING.

- (1) Apply chalk inside the brake drum, and rub it with the parking brake shoe lining.

Standard

There should be no significant defective contact.

- (2) If there is any defective contact, polish the parking brake shoe lining.

⚠ CAUTION

After inspection, wipe off the chalk.

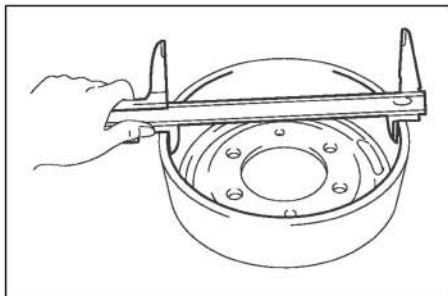

SHTS09ZZZ1800285

3. INSPECT THE BRAKE DRUM FOR WEAR AND DAMAGE.

- (1) Using vernier calipers, measure the inner diameter of the brake drum.

Permissible limit (mm {in.})	204 {8.031}
In the case of a new product (mm {in.})	203.2 {8.000}

- (2) If the brake drum is significantly partially worn, polish or replace it.

ASSEMBLING THE PARKING BRAKE DRUM (PARKING DRUM INNER DIAMETER: 203.2 mm (8.000 in.))

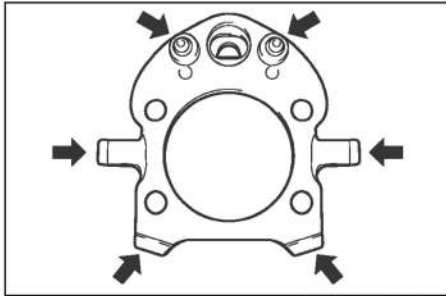

SHTS09ZZ1800286

1. APPLY GREASE.

- (1) Apply heat-resistant grease to the contact surface of the parking support plate and parking brake shoes No.1 and No.2.
- (2) Apply heat-resistant grease to the anchor, and parking brake shoes No.1 and No.2.

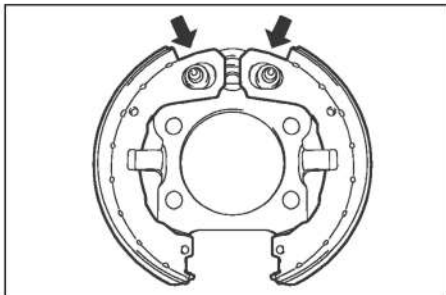

SHTS09ZZ1800287

2. INSTALL THE PARKING BRAKE SUPPORT PLATE.

- (1) Install parking brake shoes No.2 and No.1 to the parking brake support plate.

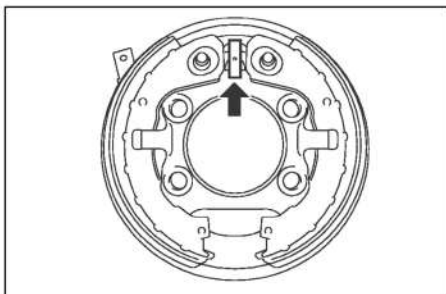

SHTS09ZZ1800288

- (2) Align and insert parking brake cam No.1 into the parking brake support plate to which parking brake shoes No.2 and No.1 have already been installed.

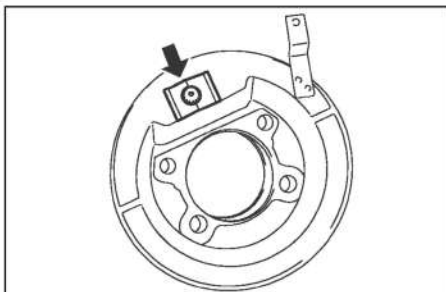

SHTS09ZZ1800289

- (3) Transmission side
 - a. Install the parking brake cam lever spring.

⚠ CAUTION

Pay attention to the direction of the parking brake cam lever spring. (Face the side that has a slit in the center toward the lever.)

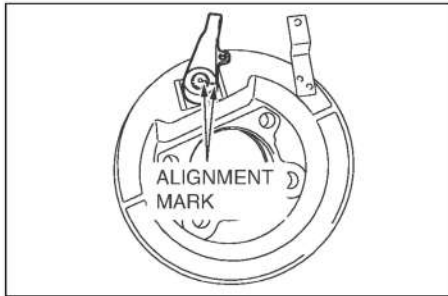

SHTS09ZZZ1800290

- b. Align the mark on the parking brake cam lever with the mark on parking brake cam No.1, then align with the installation hole for the parking brake cam lever dowel pin to install the lever.

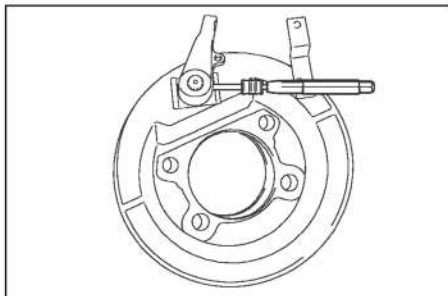

SHTS09ZZZ1800291

- c. Using a pin punch (5 mm (0.197 in.)), tap in the parking brake cam lever dowel pin to affix parking brake cam No.1 and parking brake cam lever.

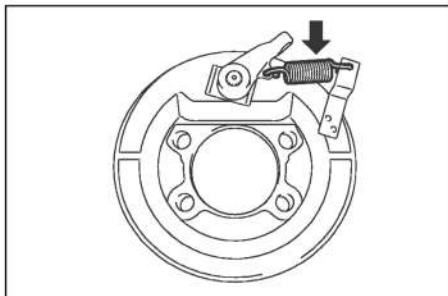

SHTS09ZZZ1800292

- d. Install the parking brake lever spring.

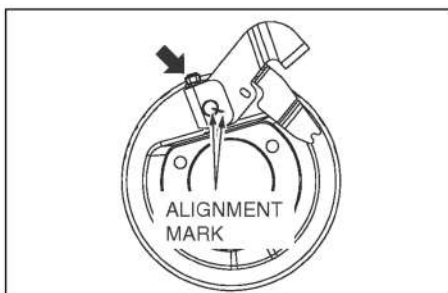

SHTS09ZZZ1800293

- (4) Transfer side
 - a. Align the mark on the parking brake cam lever with the mark on parking brake cam No.1, then align with the installation hole for the parking brake cam lever to install the lever.
 - b. Tighten the nut.

Tightening Torque:
12.7-21.6 N·m {130-220 kgf·cm, 10-15 lbf·ft}

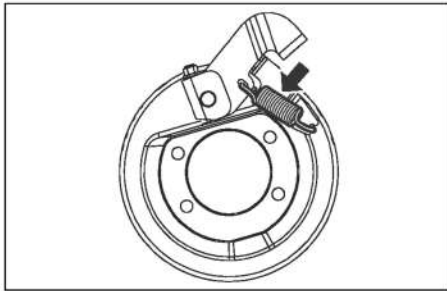

SHTS09ZZ1800294

- c. Install the parking brake lever spring.

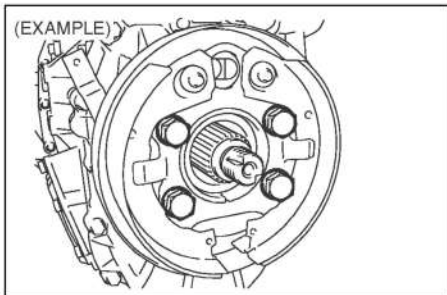

SHTS09ZZ1800295

- (5) Install the parking brake support plate with the support plate nuts (4 pcs. transmission side) or bolts (4 pcs. transfer side).

Tightening Torque:

Transmission side

155 N·m {1,581 kgf·cm, 114 lbf·ft}

Transfer side

37-49 N·m {378-499 kgf·cm, 28-36 lbf·ft}

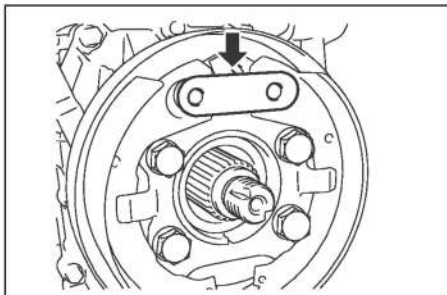

SHTS09ZZ1800296

3. INSTALL THE PARKING BRAKE BRACE (IF SO EQUIPPED).

- (1) Install the parking brake brace.

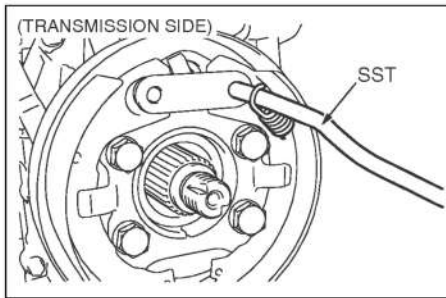

SHTS09ZZZ1800297

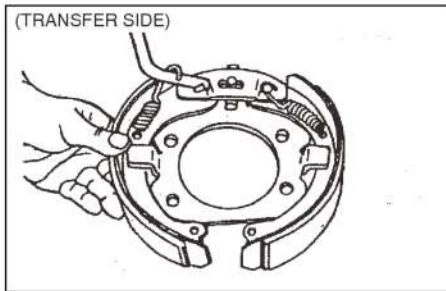

SHTS09ZZZ1800298

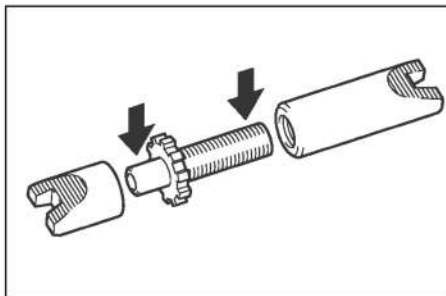

SHTS09ZZZ1800299

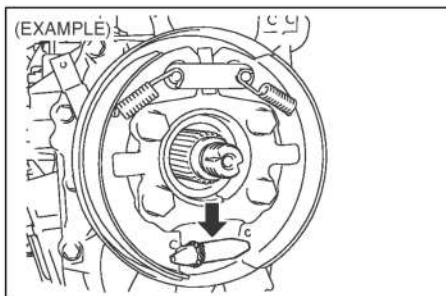

SHTS09ZZZ1800300

4. INSTALL PARKING BRAKE SHOE RETURN TENSION SPRINGS NO.1.

- (1) Using SST, install parking brake shoe return tension springs No.1 (2 pcs.).

SST: 09718-20010
Brake shoe return spring replacer
(Transmission side)
S0965-31110
Return spring hook (Transfer side)

5. INSTALL THE SHOE ADJUSTING SCREW SET.

- (1) Apply heat-resistant grease to the area shown in the figure on the parking brake shoe adjusting screw set.

- (2) Install the parking brake shoe adjusting screw set.

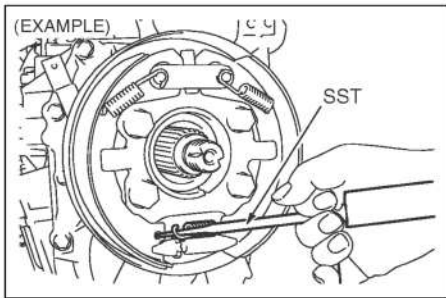

SHTS09ZZ1800301

6. INSTALL PARKING BRAKE SHOE RETURN TENSION SPRING NO.2.

- (1) Using SST, install parking brake shoe return tension spring No.2.

SST: 09921-00011
Spring tension tool

7. INSPECT THE INSTALLATION OF THE PARKING BRAKE.

- (1) Make sure that all parts are properly installed.

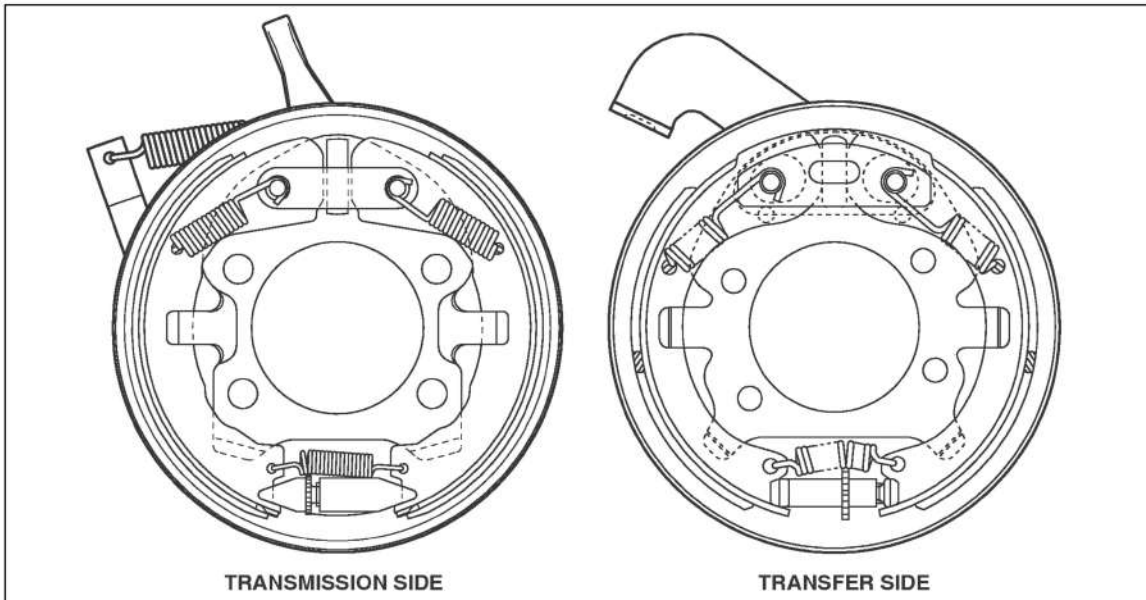

SHTS09ZZ1800302

CAUTION

Make sure that the surface of the shoe linings of parking brake shoe No.2 and parking brake shoe assembly No.1 are free from oil or water.

8. INSTALL THE PARKING BRAKE DRUM.

- (1) Align the alignment marks and install the parking brake drum.

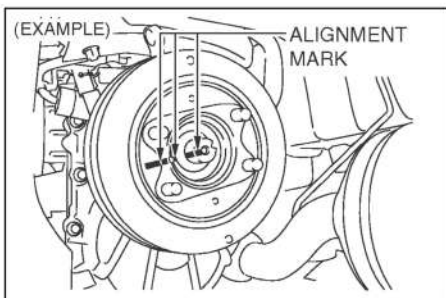

SHTS09ZZ1800303

9. INSTALL PARKING BRAKE CABLE NO.3.

Reference: BRAKE, PARKING BRAKE, PARKING BRAKE CABLE NO.3, REPLACEMENT, INSTALLING THE PARKING BRAKE CABLE NO.3 (PARKING DRUM INNER DIAMETER: 203.2 mm (8.000 in.)) (Page 9-313)

10. INSTALL THE OUTPUT SHAFT LOCK NUT (MTM).

- (1) Before tightening the lock nut, engage two gears so that the shaft can not be turned around.

Tightening Torque:
289 N·m {2,950 kgf·cm, 213 lbf·ft}

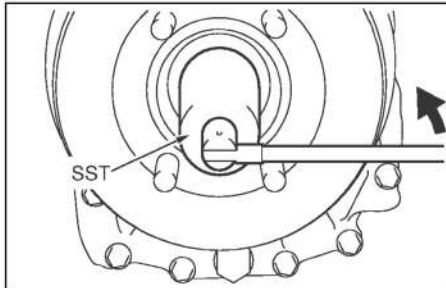

SHTS09ZZZ1800304

- (2) Install the lock nut to the output shaft and tighten it.

NOTICE

Do not damage the O-ring.

SST: 09930-00010
Deep Socket Wrench 36

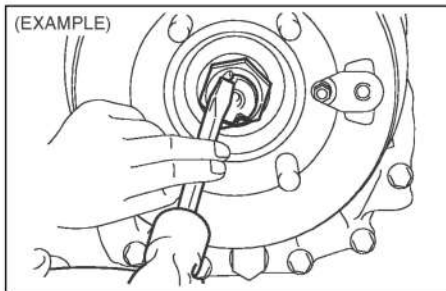

SHTS09ZZZ1800305

- (3) Using a hammer and a chisel, caulk the outside rim of the lock nut into the groove on the shaft.

"A": 1.5 mm {0.0590 in.} or more

NOTICE

Staking should be done with out rift.

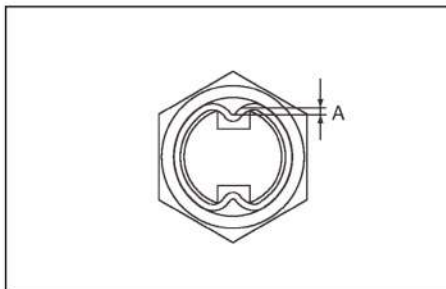

SHTS09ZZZ1800306

11. ADJUST A PARKING BRAKE SHOE CLEARANCE.

- (1) Align the adjustment hole on the parking brake drum with the position of the parking brake shoe adjusting screw.
- (2) Using a flathead driver, turn the parking brake shoe adjusting screw in the direction of "shoe expansion" so that the parking brake shoe will be completely in contact with the drum.
- (3) Turn the parking brake shoe adjusting screw in the opposite direction by 13 notches.
- (4) Make sure that there is no brake dragging.

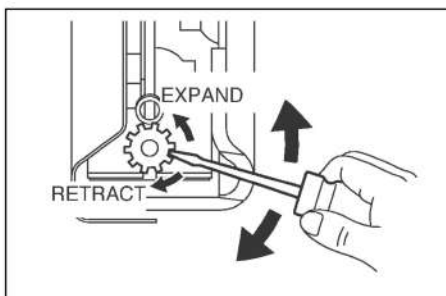

SHTS09ZZZ1800307

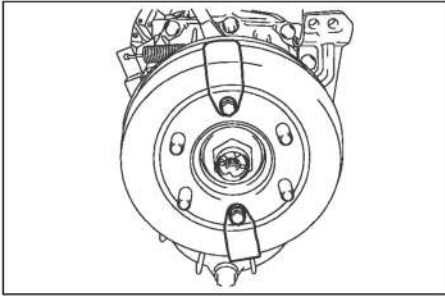

SHTS09ZZ1800308

12. INSTALL THE PARKING BRAKE DUST COVER (IF SO EQUIPPED).

- (1) Install the parking brake dust covers (2 pcs.) using the bolts (2 pcs.).

Tightening Torque:
20 N·m (204 kgf·cm, 15 lbf·ft)

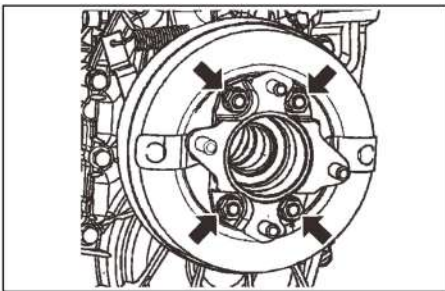

SHTS09ZZ1800309

13. INSTALL THE PROPELLER SHAFT ADAPTER (IF SO EQUIPPED)

- (1) Install the propeller shaft adapter with the nuts (4pcs.).

Tightening Torque:
93.2-112.8 N·m (951-1,150 kgf·cm, 69-83 lbf·ft)

14. INSTALL THE PROPELLER SHAFT.

Reference: PROPELLER SHAFT (LD), PROPELLER SHAFT MECHANICAL, PROPELLER SHAFT ASSEMBLY, OVERHAUL, INSTALLING THE PROPELLER SHAFT ASSEMBLY (Page 6-21)

Reference: PROPELLER SHAFT (LE), PROPELLER SHAFT MECHANICAL, PROPELLER SHAFT ASSEMBLY, OVERHAUL, INSTALLING THE PROPELLER SHAFT ASSEMBLY (Page 6-12)